

Saturn[®]

ST-CC0223

IRON



GB

IRON

Dear Buyer!
We congratulate you on having bought the device under trade name "Saturn". We are sure that our devices will become faithful and reliable assistance in your housekeeping.
Avoid extreme temperature changes. Rapid temperature change (e.g. when the unit is moved from freezing temperature to a warm room) may cause condensation inside the unit and a malfunction when it is switched on. In this case leave the unit at room temperature for at least 1.5 hours before switching it on. If the unit has been in transit, leave it indoors for at least 1.5 hours before starting operation.

READ ALL INSTRUCTIONS BEFORE USING THIS PRODUCT.

INSTRUCTION MANUAL

IMPORTANT SAFEGUARDS

- 1). Read the operation instruction carefully before putting the appliance into operation.
- 2). The appliance is designed exclusively for private use and for the envisaged purpose. This appliance does not fit for commercial use.
- 3). The supply cable must not be replaced by the user, as this requires the use of special tools. If the supply is damaged, contact an authorized service center.
- 4). Do not immerse the appliance in water.
- 5). Never leave the appliance unsupervised. To protect children from the dangers posed by electrical appliances. Make sure that the cable is hanging low and that children do not have access to the appliance.
- 6). Before filling the water tank remove the mains lead.
- 7). Do not allow the supply cable to come into contact with the ironing plate.
- 8). Before use, check that the power supply corresponds to the voltage shown on the serial number plate.
- 9). If the malfunction indicator goes on, the flatiron is not operating normally. Disconnect from the power supply and have the iron serviced by qualified service personnel in an authorized

- service center.
- 10). After use, remove the plug from the power socket and place the iron on its back cover.
- 11). This appliance is not intended for use by persons with reduced physical, sensory or mental capabilities, or lack of experience and knowledge, unless they have been given supervision or instruction concerning use of the appliance by a person responsible for their safety. Not recommended to be used by children under 14 years old.
- 12). Service life - 2 years.

Warning:

- Do not use two appliances with high power at the same time.
- Connect the appliance only to a properly power cord outlet (minimum 10A)
- Care should be taken to arrange the cord so that it cannot be pulled or tripped over.

Special safeguards

- DO NOT leave the hot iron touching fabrics or very inflammable surfaces.
- NEVER touch the appliance with wet or damp hands.
- DO NOT use the power cord or the appliance in order to pull the plug out of the socket.
- DO NOT leave the appliance exposed to the weather (rain, sun, etc.).

PLEASE NOTE!

Do not use chemical additive, scented substances or decalcifiers. Failure to comply with the above-mentioned regulations leads to the loss of guarantee.

Description

1. Spray nozzle
2. Filler cover
3. Steam dial
4. Switch lid
5. Spray button
6. Shot-steam button
7. Top cover
8. Protect wire cover
9. Power supply cord

10. Back cover
11. Body of iron
12. Light cover
13. Deck Water tank
14. Temperature-control knob
15. Self-cleaning button
16. Heat isolating
17. Sole plate
18. Water measure

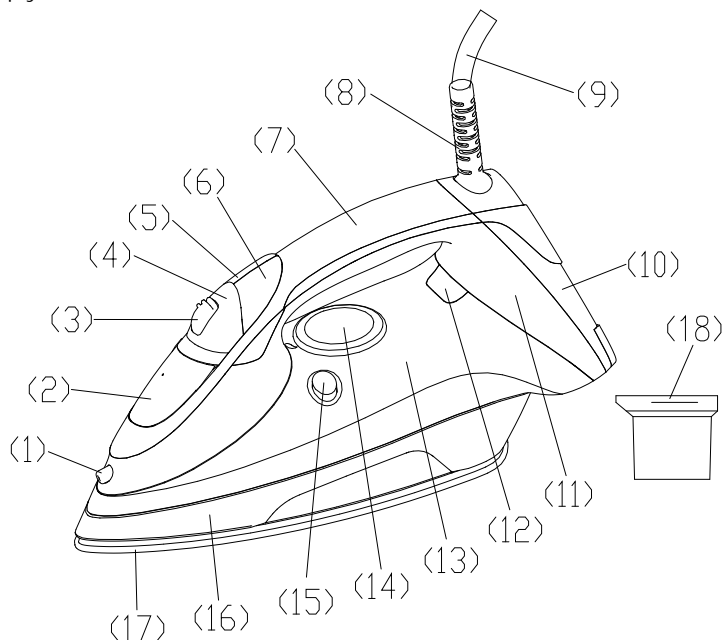

Anti-calc system

A special resin filter inside the water reservoir softens the water and prevents scale build-up in the plate. The resin filter is permanent and does not need replacing.

Please note:

Using of distilled water is recommended.

Anti-drip system

With the anti-drip system, you can perfectly iron even the most delicate fabrics.

Always iron these fabrics at low temperatures. The plate may cool down to the point where no more steam comes out, but rather drops of boiling

water that can leave marks or stains. In these cases, the Anti-drip system automatically activates to prevent vaporization, so that you can iron the most delicate fabrics without risk of spoiling or staining them.

Automatic shut-off

The automatic shut off device trips after the iron has been left for approx. eight minutes in the upright position or unused for approx. Thirty seconds in the horizontal position. The light comes on to indicate that shut off has tripped. As soon as you move the iron, the device turns off and the iron starts working again.

General instructions

Note: When using the iron for the first time, you may notice a slight emission of smoke that will stop after a short time.

We recommend passing the iron over an ordinary cloth before using it for the first time.

Preparations

Sort the laundry to be ironed according to the international symbols on the garment label, or if this is missing, according to the type of fabric.

GAR- MENT LABEL	FABRIC TYPE	THERMOSTAT REGULATION
	synthetic	low temperature
	silk - wool	.. medium temperature
	cotton - linen	... high temperature
	Fabric not to be ironed	

Start ironing the garments requiring a low temperature.

This reduces the waiting times (the iron takes less time to heat up than to cool down) and eliminates the risk of scorching the fabric.

Steam ironing

Filling the reservoir

- Check that the plug is disconnected from the socket.

- Move the steam selector (3) to " 0 " .

- Open the lid (2).

- Raise the tip of the iron to help the water enter the opening without overflowing.

- Slowly pour the water into the reservoir using the special measure (18) and taking care not to go over the maximum level indicated by " MAX " on the reservoir.

- Close the lid (2).

Selecting the temperature

- Put the iron in a vertical position.

- Put the plug in the socket.

- Adjust the thermostat knob (14) according to the international symbol on the garment label. The plate temperature pilot light (12) indicates that the iron is heating up. Wait until the plate temperature pilot light goes off before ironing.

Warning: during ironing, the plate temperature pilot light (12) comes on at intervals, indicating that the selected temperature is maintained. If you lower the thermostat temperature after ironing at a high temperature, do not start ironing until the plate temperature control light comes on again.

Selecting the steam

The quantity of steam is regulated by the steam selector (3).

- Move the steam selector to a position between minimum and maximum depending on the quantity of steam required and the temperature selected.

Warning: the iron gives off steam continuously only if you hold the iron horizontally. You can stop the continuous steam by placing the iron in a vertical position or by moving the steam selector to "0". As indicated on the thermostat knob (14) and in the initial table, you can only use steam at the highest temperatures. If the selected temperature is too low, water may drip onto the plate.

Selecting shot-steam and steam when ironing vertically.

Press the shot-steam button (6) to generate a powerful burst of steam that can penetrate the fabrics and smooth the most difficult and tough creases. Wait for a few seconds before pressing again.

By pressing the shot-steam button at intervals you can also iron vertically (curtains, hung garments, etc.)

Warning: the shot-steam function can only be used at high temperatures. Stop the emission when the plate temperature pilot light (12) comes on, than start ironing again only after the light has gone off.

Dry ironing

To iron without steam, follow the instructions in section "steam ironing", leaving the steam selector (3) on position "0".

Spray Function

Make sure that there is water in the reservoir. Press the spray button (5) slowly (for a dense spray) or quickly (for a vaporized spray) [Fig. 6].

Warning: for delicate fabrics, we

recommend moistening the fabric beforehand using the spray function (5), or putting a damp cloth between the iron and the fabric. To avoid staining, do not use the spray on silk or synthetic fabrics.

Cleaning

Please note: before cleaning the iron in any way, make sure that the appliance plug is not connected to the socket.

Any deposits, starch residue or size left on the plate can be removed using a damp cloth or an unabrasive liquid detergent. Avoid scratching the plate with steel wool or metallic objects. The plastic parts can be cleaned with a damp cloth then wiped over with a dry cloth.

Self-cleaning

The self-cleaning feature cleans inside the plate, removing impurities. We recommend using it every 10-15 days.

Directions:

-Fill the reservoir up to the maximum level indicated and set the steam selector (3) to "0"

-Set the thermostat knob (14) to the maximum temperature and wait for the pilot light (12) to turn off.

-Pull the plug out of the socket and hold the iron horizontally over the sink.

-Hold the cleanout button (15) setting until all the boiling water, steam, impurities come out.

-When the soleplate has cooled down, you can clean it with a damp cloth.

How to put it away

- Disconnect the plug of the iron from the socket.

- Empty the reservoir by turning the iron upside down and gently shaking it.

- Leave the iron to cool down completely.

- Roll up the power cord with the rewinder.

- Always put the iron away in a vertical position.

Advice for good ironing

• We recommend using the lowest temperatures with fabrics that have unusual finishes (sequins, embroidery, flush, etc.).

• If the fabric is mixed (e.g. 40% cotton 60% synthetics), set the thermostat to the temperature of the fibre requiring the lower temperature.

• If you don't know the composition of the fabric, determine the suitable temperature by testing on a hidden corner of the garment. Start with a low temperature and increase it gradually until it reaches the ideal temperature.

• Never iron areas with traces of perspiration or other marks: the heat of the plate fixes the stains on the fabric, making them irremovable.

• The size is more effective if you use a dry iron at a moderate temperature: excess heat scorches it with the risk of forming a yellow mark.

• To avoid marking silk, woolen or synthetic garments shiny, iron them inside out.

• To avoid marking velvet garments shiny, iron in one direction (following the fibre) and do not press down on the iron.

• The heavier the washing machine is loaded, the more garments come out creased. This also happens when the spin drying revolutions are very high.

• Many fabrics are easier to iron if they are not completely dry.

• For example, silk should always be ironed damp.

Specification

Power: 2200 W
 Rated voltage: 220-230 V
 Rated frequency: 50 Hz
 Rated current: 10 A

Set

IRON 1
 INSTRUCTION MANUAL WITH WARRANTY CARD 1
 PACKAGE 1

ENVIRONMENT FRIENDLY DISPOSAL



You can help protect the environment! Please remember to respect the local regulations: hand in the non-working electrical equipment to an appropriate waste disposal center.

The manufacturer reserves the right to change the specification and design of goods.

RU

10.

11.

"Saturn".

14

12.

- 2

1,5

1,5

(10)

1.

2.

3.

4.

5.

6.

7.

8.

9.

- 1.
- 2.
- 3.
- 4.
- 5.
- 6.
- 7.
- 8.
- 9.

- 10.
- 11.
- 12.
- 13.
- 14.
- 15.
- 16.
- 17.
- 18.

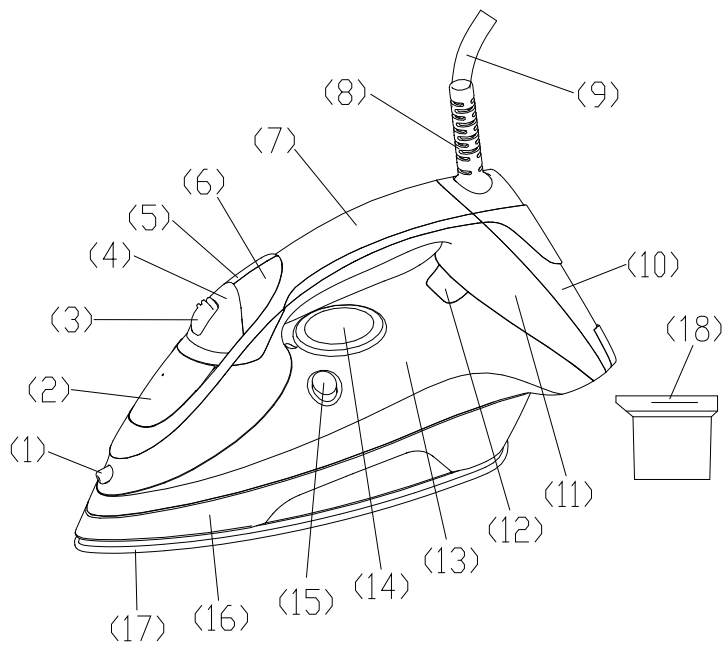

MAX "

-
-
-
-

(12),

" 0 "

()

-
-
-
-

(3)

" 0 "

(

8

30

8

(18).

9

"
0".

(5)

)

•
•
•
•
•

•

•

•

•

•

•

•

•

•

•

10-15

"0".

(14)

(12).

(15)

2200
: 220-230
50
: 10

1

1

1



UA

! "Saturn".

1,5

1,5

1.

2.

3.

4.

5.

6.

7.

8.

9.

10.

11.

12.¹⁴

-2

(10).

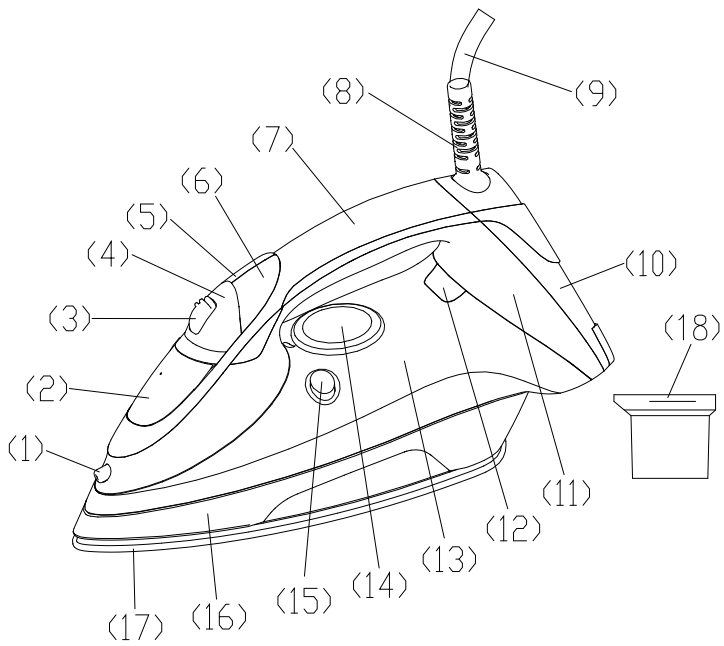

- 1.
- 2.
- 3.
- 4.
- 5.
- 6.
- 7.
- 8.
- 9.
- 10.
- 11.
- 12.
- 13.
- 14.
- 15.
- 16.
- 17.
- 18.

8

30

(12),

	-	..
	-	...

"0".

"0".

(3)

(18).

"MAX"

15

"0".

(14)

(12).

(15)

2200
220-230
50
10

1

1
1



(

(

40%

60%

(5)

(

)

10-

Saturn®

INTERNATIONAL MANUFACTURER'S WARRANTY

MEZINÁRODNÍ ZÁRUKA

GB

INTERNATIONAL MANUFACTURER'S WARRANTY

The Warranty is provided for the period of 2 years or more if the Law on User Right of the country where the appliance was bought provides for a greater minimum warranty period.

All terms of warranty comply with to the Law on Protection of the Consumer Rights and are governed by the legislation of the country where the product was bought. The warranty and free of charge repair are provided in any country where the product is delivered to by Saturn Home Appliances or authorized representative thereof, and where no restriction of import or other legal provisions interfere with rendering of warranty services and free of charge repair.

Cases uncovered by the warranty and free of charge repair:

1. Guarantee coupon is filled in improperly.
2. The product has become inoperable because of the Buyer's nonobservance of the service regulations indicated in the instruction.
3. The product was used for professional, commercial or industrial purposes (except for the models, specially intended for this purpose that is indicated in the instruction).
4. The product has external mechanical damage or damage caused by penetration of the liquid inside, dust, insects and other foreign objects.
5. The product has damages caused by non-observance of the rules of power supply from batteries, mains or accumulators.
6. The product was exposed to opening, repair or modification of design by the persons, unauthorized to repair; independent cleaning of internal mechanisms etc. was made.
7. The product has natural wear of parts with limited service life, expendables etc.
8. The product has deposits of scale inside or outside of fire-bar elements, irrespective of used water quality.
9. The product has damages caused by effect of high (low) temperatures or fire on non-heat resistant parts of the product.
10. The product has damages of accessories and nozzles which are included into the complete set of product shipment (filters, grids, bags, flasks, cups, covers, knives, sealing rings, graters, disks, plates, tubes, hoses, brushes, and also power cords, headphone cords etc.).

On the warranty service and repair, please contact the authorized service centers of "Saturn Home Appliances".

MEZINÁRODNÍ ZÁRUKA

Záruka se poskytuje na dobu 2 roky. V případě, že Zákon na ochranu spotřebitele dané země stanoví delší dobu, prodlužuje se záruka na tuto dobu.

Veškeré záruční podmínky odpovídají Zákonu o ochraně práv uživatelů a jsou řízeny zákonodárstvím státu, kde byl výrobek koupen.

Záruka a bezplatná oprava se poskytují v každém státě, kam jsou výrobky dodány společností „Saturn Home Appliances“ nebo jejím zplnomocněným zástupcem a kde nejsou žádná omezení na dovoz nebo jiné právní předpisy omezující poskytnutí záručního servisu a bezplatné opravy.

Případy, na které se záruka a bezplatná oprava nevztahují

1. Záruční list je vyplněn nesprávně.
2. Výrobek byl poškozen kvůli tomu, že zákazník nesplnil pravidla použití, která jsou uvedena v návodu.
3. Výrobek byl používán k profesionálním, komerčním nebo průmyslovým účelům (kromě modelů speciálně určených pro tyto účely, což je uvedeno v návodu).
4. Výrobek má vážnější mechanická poškození nebo poškození, vyvolaná tím, že se dovnitř dostala tekutina, prach, hmyz a jiné cizí předměty.
5. Výrobek má poškození, která jsou vyvolána nesplněním pravidel napájení od baterií, sítí nebo akumulátorů.
6. Výrobek rozebírali, opravovali nebo modifikovali jeho konstrukci lidé, kteří nebyli zplnomocněni k opravě, bylo provedeno samostatné čištění vnitřních mechanismů a pod.
7. Výrobek má přirozené opotřebení dílů s omezenou dobou použití, spotřebních materiálů atd.
8. Výrobek má vrstvu usazeniny uvnitř nebo zvenku termoelektrických ohříváků, bez ohledu na kvalitu používané vody.
9. Výrobek má poškození, která jsou vyvolána působením vysokých (nízkých) teplot nebo ohněm na termonestabilní části výrobku.
10. Výrobek má poškození příslušenství a nástavce, které jsou dodány spolu s výrobkem (filtry, sítky, sádky, baňky, mísy, víka, nože, šlehače, struhadla, kotouče, talíře, trubky, hadice, kartáče a také síťové šňůry, sluchátkové šňůry atd.).

V otázkách záručního servisu a oprav se obraťte na autorizovanou servisní střediska společnosti „Saturn Home Appliances“.

2

«Saturn Home Appliances»

1.

2.

3.

4.

5.

6.

7.

8.

9.

10.

«Saturn Home Appliances».

					LCD		
.4	" "	8-988-993-37-78	+		+	+	+
.18	,	8(8553) 32-22-11 8-960-047-22-11	+	+	+	+	+
.98	« - »	8(86133) 6-09-84, 8-918-215-57-75	+	+	+	+	+
.48, .108	" - "	.8(3955) 67-00-44, .8(3955) 56-61-77	+	+	+		+
109	-	8(86152)2 -81-99	+	+	+	+	+
.1, .1, 12	« -29»	8(8182) 44-15-55	+				
.47	« »	8(8512)25 -19-39 8(8512) 25-12-00	+	+	+		
16, 2 .7	« »	8(8512) 54-67-67, 8(8512) 54-91-91				+	+
.15	« »	8(85141) 3-61-25	+	+	+	+	+
32		8-927-552-47-21, 8-937-122-13-99				+	+
.113	« »	8(3852) 63-94-02	+		+	+	+
.9, .25		8-905-425-60-4-73	+	+	+		
37		8(8635) 47-47-72, 8(8635) 47-47-72	+	+	+	+	+

.63	« »	8(86155)3 -11-00, 8-918-980-64-75	+	+	+	+	+
.84		8(86559) 2-08-02, 8(86559)5 -29-71	+	+	+	+	+
58	« »	8(8442) 23-41-36, 8(937) 717-93-34	+		+		
173	« »	8(8442) 97-50-10, 8-960-883-59-00			+		
4		8(8442) 98-16-47, 8(8442) 53-06-04	+	+	+	+	+
	« »	8-961-688-53-48			+		
		8-927-521-52-00			+	+	+
		8-937-722-68-12				+	+
158		8-937-730-66-03			+	+	+
		8-904-404-14-55				+	+
C .12/15	«Master»	8-928-126-63-66	+		+		
.77- .65	« »	8(937) 717-93-36	+		+		
.65	« »	8(8172) 70-03-45, 8(8172) 54-21-54	+		+	+	+
.1	« »	8(8172) 52-72-51	+		+		

8(473) 260-09-08, 8(473) 240-57-73	+		+	+		
8(87951) 6-47-93, 8-928-654-28-01			+			
8-962-655-20-00	«	»	+	+	+	+
8(8313) 21-14-14	«	»	+		+	
8(8313) 20-93-00, 8(8313) 20-92-94	«	»			+	
8(84235) 2-86-59, 8(84235) 9-14-64	"	"	+		+	+
8(86132) 2-11-71, 8(86132) 3-66-02	«	»	+	+	+	+
8(343)240 -26-60	"	"	+		+	
8(343) 201-51-41, 8(343)347 -76-83	/	"	+	+	+	+
8(47467) 4-12-08, 8(47467) 4-33-17	«	»	+		+	
8(4932) 335185, 8(4932) 335236	«	- »	+	+	+	+
8(3412) 30 79-79, 8(3412)30 -83-07	«	- »	+		+	+
8(3412) 78-76-85, 8(3412) 78-06-64	«	- »	+		+	+
8(3412) 44-60-40, 8(3412) 44-60-67	«	- »			+	

8(86545) 2-74-74	« 26»		+			
8(8362) 24-11-24, 8(8362) 25-55-40	«	»	+	+	+	+
8(39520) 65-04-95, 8(39520) 93-16-56	«	»	+		+	+
8(3952) 42-55-76, 8(3952) 78-15-83	"	"	+		+	
8(843) 248-71-17, 8(843) 258-85-65	«	»	+		+	
8(4842) 54-82-22, 8(4842) 54-83-33	«	»	+	+	+	+
8(3439) 39-95-20, 8(3439)3 4-74-40	-		+	+	+	+
8(3842) 35-39-67	-		+		+	
8(8332) 56-25-95, 8(8332) 54-70-77	«	- »	+		+	+
8-988-548-24-36	-		+	+	+	
8(4942) 300107, 8(4942) 300107	«	»	+		+	+
8(86142)4 -43-59			+	+	+	+
8(861) 267-50-88	-	-	+	+	+	+
8(861) 222-64-13, 8(861)	«	- »				

.103, .55		222-85-55, 8-905-408-08-38					
.42/2		8-918-041-31-04, 8(86131) 71-2-72		+			+
116		8(86164) 7-01-22		+			
57	" "	8(86145) 3-78-74	+	+	+	+	+
.25	« »	8(86164) 65-4-95, 8-918-355-81-70	+	+		+	+
.1		8(86153) 4-16-70		+			
168	" "	8(86151) 4-33-54, 8-918-464-00-86	+	+		+	+
.1	« »	8(3912) 93-54-33, 8(3912) 94-52-82	+	+	+	+	+
.36- .37-	« +»	8 (4712) 50-85-90, 8 (4712) 35-04-91	+	+	+	+	
.2	« »	8 (86169) 7-39-99, 8(86169) 7-24-96	+	+	+	+	+
.66	" "	8(4742) 33-45-65, 8(4742) 33-45-95	+	+	+	+	+
.29	« »	8 (8772) 52-36-90	+	+	+	+	

.25	« » -	8 (8772) 55-62-38		+			+
.20	« »	8(8722) 93-30-73	+	+	+	+	+
11	« »	8(86385) 2-33-26 8-960-458-07-11	+	+		+	+
.9	« »	8 (499) 340-29-89, 8 (499) 733-25-00		+			
1534	« - »	8(499) 717-82-07, 8(499) 717-82-12	+		+	+	+
.3 (. .)	« »	8(495) 721-30-70, 8(499) 168-05-19, 8(499) 168-47-15	+		+	+	+
(30/05)	« »	8(8552) 359002, 8(8522) 359042	+	+	+		
.24	" - "	8(8662) 42-04-30 8(8662) 42-12-21	+		+	+	
.55	« »	8(86554) 5-59-77, 8(86554) 3-67-57	+	+	+	+	+
.9 (. « »)	« »	8(8555) 48-08-80, 8-917-906-60-06	+		+	+	+
.21	« »	8(831) 229-63-66, 8(831) 229-60-87	+		+	+	
.18	« - »	8(831) 46-18-848		+			+
.6	« - »	8(831) 46-18-848		+			+
18	« »	8 (3843) 20-31-33	+		+	+	+

14	« - »	8(8617) 63-11-15, 8(8617) 63-03-95	+	+	+	+	+
17	" - "	8(383)274 -99-33, 8(383) 274-99-45	+		+		
24		8(86369) 3-74-75, 8-928- 609-35-85	+	+	+		
4		8 (3532) 36-87-94	+			+	+
16	« - »	8(3532) 77-67-64, 8(3532) 78-15-82	+	+	+	+	+
130	" "	8(3812)36 -42-02	+		+	+	+
2	« - +»	8(3537) 33-84-43, 8(3537) 35-13-18	+	+	+	+	+
2	« »	8(8412) 26-09-60, 8(8412) 26-12-29	+		+	+	+
3,	« - »	8 (342) 221-40-99	+	+	+	+	+
11	« - »	8(8142) 78-06-93, 8(8142) 70-65-48	+		+		
11	« »	8 (8112)- 53-86-30, 8 (8112)- 53-86-50	+		+		
12		8(793) 31- 84-16	+	+	+	+	+
5- 13	" "	8(8793) 98-70-11	+	+	+	+	+

148		8(47396) 48-911	+	+	+	+	+
37	« - »	8(863) 250-47-77	+		+		
50- 1/52, 55	« »	8 (863) 21-92- 112, 8- 800-100- 51-52	+	+	+	+	+
11 /17		8-906- 453-35-81	+		+		
12	« »	8(4855) 22-04-77, 8(4855) 25-38-60	+	+	+	+	+
14	" "	8(86370) 2-19-50	+	+	+	+	+
12	" "	8(4855) 22-04-77, 8(4855) 25-38-60	+	+	+	+	+
21	« »	8(4855) 24-31-21	+	+	+	+	+
14, 1	« - »	8(4912) 76-88-01, 8(4912) 40-30-30	+	+	+	+	+
42 " "	« - »	8(4912) 41-33-02,	+	+	+	+	+
52, 8, 9		8(846) 931-85-46	+	+	+	+	+
63	" - "	8(846) 379-54-54	+	+	+	+	+
197	« XXI» -	8(812) 600-11-97	+	+	+	+	+

е 41,	« - »	8(812) 325-36- 56, 8(812) 325-36-57	+		+	+		
е 11, 36	95» « - »	8(812) 822-18- 00, 8(812) 320-06-61	+					
1	« - »	8(8342) 23-05-91, 8(8342) 47-48-59	+	+	+			
3- " - " - »	« - »	8(8452) 35-11-80, 8(8452) 55-43-63	+	+	+	+	+	+
7/1 16		8- 951-522- 38-11	+	+	+	+	+	+
253	« »	8(496) 547-04- 95, 8(496) 549-32-79	+	+		+	+	+
90	« »	8 (8622)55- 51-19, 8 (8622) 55- 01-08	+			+	+	+
50 8/1	« »	8(8652) 74-01-91	+	+	+			
63	« »	8(8652) 24-30-14, 8(8652) 23-31-81	+	+	+	+	+	+
15 21	« »	8(8652)95 -53-68, (8652)95- 61-90			+			
1	« - »	8 (4725) 24-62-27, 8 (4725) 24-73-49	+		+	+		
158	« - »	8(3473) 20-12-13, 8(3473) 20-27-70	+		+	+	+	+

25	« »	8(8212) 22-95-29, 8(8212) 29-12-20	+	+	+	+	+	+
137	2000» « - »	8(4752) 56-19-42, 8(4752) 56-19-44	+	+	+	+	+	+
88/15	-	8-910- 834-80- 35, 8-952- 065-89-10	+			+		
24/2		8(86130) 4-86-59, 8-918- 147-02-03	+	+			+	+
2/2	" - " -	8(86196) 7-20-53	+	+	+	+	+	+
48	« +»	8(8482) 22-72-41, 8(8482) 22-71-85, 8(8482) 61-65-64	+	+	+	+	+	+
58	« -2»	8(3822) 56-23-35, 8(3822) 48-08-80	+			+		
137	« »	8(4872) 31-12-57	+	+	+	+	+	+
55	" "	8(3452) 47-35-69	+			+	+	+
28	« »	8(3012) 21-89-63	+			+	+	+
18, 2	18, »	8(8422) 31-00-00	+	+	+	+	+	+
16/7	« »	8(8422)73 -44-22, 8(8422) 73-29-19	+	+			+	+
378	« »	8(87875) 7-44-82	+	+	+			
148	« »	8(3472) 77-12-62	+			+		

153, 42, 7	« »	8(347) 279-90-70, 8(347) 241-62-02						+
15	" "	8(86391) 2-18-06	+		+			
36	« »	8(8352) 62-30-97, 8(4942) 63-20-98	+		+			
102	-	8(351) 772-72-05, 8(351) 772-73-66, 8(351) 772-69-01	+	+	+	+	+	+
8	-	8(351) 239-39-34, 8(351) 239-39-35	+	+	+	+	+	+
18	« »	8(8202) 54-31-88	+		+	+	+	+
340" "	« - »	8(8782) 27-30-60, 8(8782) 27-70-77	+	+	+	+	+	+
48, 11	" "	8(8782)25 -04-66, 8(8782)25 -19-15	+	+	+	+	+	+
1		8-904-345-83-18	+	+	+	+	+	+
3-21	« »	8 (84722) 9-52-07, 8-937-469-52-07	+	+	+	+	+	+
57	« - »	8(8453) 55-80-89, 8-964-848-45-06	+		+	+	+	+

12	« - »	8 (4852) 25-94-83	+		+		
----	-------	-------------------	---	--	---	--	--

UA

- 2
- «Saturn Home Appliances»
- 1.
- 2.
- 3.
- 4.
- 5.
- 6.
- 7.
- 8.
- 9.
- 10.

«Saturn Home Appliances».

				/	-	-
1	,36	Hi-Fi	(064) 424-89-50	+	+	+
2	,14		(065)632 21 83, 050-904-57-17	+	+	+
3	,66		062744-60- 38(39)	+	+	+
4	,49	-	(04563) 633-19	-	+	-
5	.50- ,82	-	(045) 63-68-413	+	+	+
6	,57		(041) 43-406-36	+	+	-
7	,43	" "	(0314 1) 43-432	+	+	+
8	,3, .8	-	(044) 332-01-67	+	+	+
9	,42	-	(0432) 46-50-01	+	+	-
10	,61		(0432) 61-95-73	+	+	+
11	,16	-	(0432) 464393; (0432) 468213	+	+	+
12	,3		(0432) 64-24- 57, (0432) 64-26-22	+	+	+
13	,1		(0432) 509-191, 579-191	+	+	+
14	68,1 , .420		(0562) 337-574	+	+	+
15	,17 .130	-	(056) 778-63-25 (28)	+	+	+
16	,59		(0562) 35-04-09	+	+	+

17	,118		(0562) 67-60-44	+	+	+
18	,41		(056) 790-04-60	+	+	+
19	,9		(068) 851-33-33	+	+	+
20	188		(062) 345-06-07	+	+	+
21	,129	-	(062) 349-26-81	+	+	+
22	,1	-	(062) 302-75-69	+	+	+
23	,8	" "	(0412) 471-568	+	+	-
24	,4 .222		(067) 410 2198	+	+	+
25	,24	C	(0412) 47-07- 42, 42-11-53	+	+	-
26	,50	-	(061) 220-97-65 (64)	+	+	+
27	,175		(061) 701-65-96	+	+	+
28	,83	-	(061)212-03-03	+	+	+
29	,75		066-085-75-39	+	+	+
30	,19		(0342)559-525, 750-777	+	+	+
31	,14		(0342) 754737	+	+	-
32	,9	-	(048) 734-71-90	+	+	+
33	,76		(04597) 551-62	+	+	-

34	,161, ()	-	(04736) 629-49	+	+	+
35	, 1	-	(044) 591-11-90	+	+	+
36	, . ,1	" "	(044) 4269198	+	+	-
37	, 57	-	(044) 369-5001 (063) 486-6999	+	+	+
38	, ,10		(06272) 2-62- 23, (050) 279-68-16	+	+	+
39	, ,1	" "	(0522) 301-456	+	+	+
40	, ,2		(0522) 35-79-23	+	+	+
41	, ,98	-	(0522) 270- 345,349-585	+	+	+
42	, ,13		(097) 264-21- 67, 776-67-70	+	+	+
43	, .5	" "	(04142) 5-05-04	+	+	+
44	, ,15-106		(06264) 5-93-89	+	+	+
45	, ,7		(050) 526-06-68	+	+	+
46	, ,44, .1		(05366) 39-192	+	+	-
47	, ,42		(056) 401-33- 56, 404-00-80, 474-61-03	+	+	+
48	, ,9		056-4092302 (03)	+	+	+
49	, ,64/7		(0564) 40-07-79	+	+	+
50	, ,73	" "	(056) 440-07-64	+	+	+

51	, ,81		(050) 214-91- 73; (066) 017- 02-03	+	+	+
52	, ,49	-	(0642) 505-783	+	+	+
53	50		(0642)50-57-83	+	+	+
54	, ,96		(0642) 494-217, 33-11-86	+	+	+
55	, ,1	-	(0332)290752	+	+	+
56	, ,15		(032) 244-53-44	+	+	+
57	, ,35	" "	(032) 2973631	+	+	+
58	, 2		(032) 247-14-99	+	+	+
59	, ,116	" "	(032) 245-80-52	+	+	-
60	, ,28		(032) 239-51-52 (032) 239-55- 77,295-50-28, 295-50-29	+	+	+
61	, ,9	" "	032-267-63-26	+	+	-
62	, 242		(062)322-55-50	+	+	+
63	, ,2	-	04337- 64847;0432- 468213	+	+	+
64	, ,24/1		(099) 262-11-18	+	+	+
65	, ,46		(03131)37-337, 37-336	+	+	-
66	, ,50 ,32/18		(0629) 41-06-50	+	+	+

67	- . , 227	" - "	(0629) 473-000	+	+	+
68	. , 33,	" "	(0512) 580-555	+	+	+
69	. , 49	" "	0512-58-21-80	+	+	+
70	, 2		(0512) 58-06-47	+	+	+
71	, 62	-	(05662) 22-488, (097) 402-71-95	+	+	-
72	. , 97, . 2	" , - "	(05662) 4-15-03	+	+	-
73	. , 38	. .	(055) 497-26-17	+	+	-
74	. - , 38	" "	(041)4152010	+	+	-
75	(. , 66 2)		048-7317704; 7317703;	+	+	+
76	, 90		(048) 700 17 37	+	+	+
77	, 55	" "	(048) 715-10- 25, (0482) 39- 06-18	+	+	+
78	. , 67	" "	8(05632) 6-15- 54, (05632) 6- 23-42	+	+	-
79	, 26		050-013-72-17, 0532-509889	+	+	+
80	, 14		(0532) 69-42-62	+	+	+
81	. 21	-	(0532) 69-09-46 (093)562-81-25	+	+	+
82	, 66		(0532)615-621	+	+	+

83	, 371	-	(04637)53-982 (093)753-38-28	+	+	+
84	, 101/1		(046) 3738595	+	+	+
85	, 12	-	(0362) 26-67- 53,26-65-85	+	+	-
86	, 26		(0692) 55-56- 43, 45-36-99	+	+	+
87	, 72	-	(0652)-69-07-78	+	+	+
88	, 17/1	" - "	(0652) 522-771	+	+	+
89	, 32	-	(04733)-46-182	+	+	-
90	, 15 ()		(06444)40289	+	+	+
91	, 171 /10	-	(245) 53-136	+	+	+
92	, 19		(0542) 705-296	+	+	-
93	, 17	SLT- Service	(0542) 78-10-13	+	+	+
94	, 2	" "	(0352) 26-30- 13, 23-17-97	+	+	-
95	, 1/24	" - "	(047) 44-46- 614,(047) 44- 46-134	+	+	+
96	, 101		(0312) 661-297	+	+	+
97	, 12		(057) 717-13- 39, 702-16-20	+	+	+
98	, 3		(057) 734-97- 24, 712-51-81	+	+	-
99	, 18 (- 42)	" "	(096) 595-37-46	+	+	+

100			(03142) 42-258	+	+	+
101			(0552) 29-60-42	+	+	+
102			(0552) 43-40-33	+	+	+
103			(0552) 420-235	-	-	+
104			(0382)78-37-55, 78-37-73	+	+	+
105		-	(0382) 723-241, 723-240	+	+	+
106			097-549-20-36	+	+	+
107			0472-633-728	+	+	+
108			(0472) 435-389	+	+	+
109		" - "	(0472) 563-478, 500-354, (096) 505-63-63	+	+	+
110			(0462) 601585	+	+	+
111			(0462) 724872,724949	+	+	+
112			(0372) 55-48- 69,90-13-11	+	+	+
113			(0372) 58-43-01	+	+	+
114		" - "	(050) 373-73-71	+	+	+
115		(-)	(050) 324-43-01	+	+	-

GB

WARRANTY COUPON

**When purchasing the product,
please require its checking before you;
BE SURE
that the goods sold to you, are functional and complete
and that the warranty coupon is filled in correctly.**

This warranty coupon confirms the absence of any defects in the product you purchased and provides for free of charge repair of the product failed through the fault of the manufacturer throughout the period of warranty service and free of charge repair.

Failing the presentation of this coupon, in case of its improper filling in, infringement of factory seals (if any), and also in cases indicated in the warranty obligations, the claims are not accepted, and no warranty service and free of charge repair is made!

The warranty coupon is valid only in the original copy with the stamp of trading organization, signature of the seller, date of sale and signature of the buyer.

CZ

ZÁRU NÍ LIST

**P i koupi výrobku
žádejte o jeho vyzkoušení ve Vaší přítomnosti,
P E S V D T E S E,
že Vám prodaný výrobek je dobře fungující a kompletní
a že záru ní list je vyplněn správně.**

Tento záru ní list potvrzuje, že na Vámi koupeném výrobku nejsou žádné vady a zajišťuje bezplatnou opravu nefungujícího přístroje z viny výrobce, bez ohledu na dobu.

Bez předložení tohoto listu, při jeho nesprávném vyplnění, porušení plomb výrobce (jsou-li na výrobku) a také v případech, které jsou uvedené v záručním listě, nároky se nepřijímají a záruční oprava se neprovádí!

Záruční list je platný jenom jako originál s razítkem obchodní organizace, podpisem prodávatele, termínem prodeje a podpisem zákazníka.

RU

Saturn®

WARRANTY COUPON

ZÁRU NÍ LIST

SATURN HOME APPLIANCES S.R.O. KON VOVA 141/2660
13083 PRAHA 3 – ŽIŽKOV, ESKÁ REPUBLIKA, TEL: + 4202/ 67 108 392

Model /

Production number/Výrobní íslo/
/

Date of sell/Termín prodeje/ /

Shop stamp/Razítko obchodu/ /

Seller's signature/Podpis prodava e/ /

Buyer's Signature confirming the acquaintance and consent with conditions of free of charge maintenance service of the product, and absence of the complaints on appearance and color of the product.
Podpis zákazníka, potvrzující seznámení a souhlas s podmínkami bezplatného záru ního servisu výrobku, a také neexistence nárok na vn jšek a barvu výrobku.



UA

Saturn	Saturn	Saturn
Model / /	Model / /	Model / /
Production number /	Production number /	Production number /
Name of the Trade Company /	Name of the Trade Company /	Name of the Trade Company /
Stamp of the Trade Company/ /	Stamp of the Trade Company/ /	Stamp of the Trade Company/ /
Client Address/Phone # / /	Client Address/Phone # / /	Client Address/Phone # / /
Date of Receiving/ /	Date of Receiving/ /	Date of Receiving/ /
Defect / /	Defect / /	Defect / /
Signature, Stamp / , /	Signature, Stamp / , /	Signature, Stamp / , /
COUPON 1	COUPON 2	COUPON 3