

Saturn[®]

ST-CC0232

STEAM IRON



GB

STEAM IRON

Dear Buyer!
 We congratulate you on having bought the device under trade name "Saturn". We are sure that our devices will become essential and reliable assistance in your housekeeping.
 Avoid extreme temperature changes. Rapid temperature change (e.g. when the unit is moved from freezing temperature to a warm room) may cause condensation inside the unit and a malfunction when it is switched on. In this case leave the unit at room temperature for at least 1.5 hours before switching it on. If the unit has been in transit, leave it indoors for at least 1.5 hours before starting operation.

IMPORTANT SAFE GUARDS

Please be care of the dangerous steam splash when using the appliance;
 Please pull plug out when filling water or cleaning the appliance;
 Use the appliance only as described in this manual. Improper operation may cause fire or electric shock.

Do not immerse the unit, power cord or plug into water.
 Do not leave the steamer unattended while it is in operation.

This appliance is not intended for use by persons (including children) with reduced physical, sensory or mental capabilities, or lack of experience and knowledge, unless they have been given supervision or instruction concerning use of the appliance by a person responsible for their safety.

Children should be supervised to ensure that they do not play with the appliance.

Do not operate the steamer without filling the water tank. Always check the water level before use and during operation.

Do not lay the hose on the ground or fold it.

Do not touch hot metal parts, hot water or steam spout to avoid burns.

Move the appliance by rotating the telescopic pole. Do not force the casters if they are stuck. Turn off the unit, drain the water tank and water reservoir before inspecting the casters.

Wait for at least 30 minutes till the appliance cool completely and drain the water tank and water reservoir before storage.

Always disconnect the appliance from the outlet before filling or draining water. Be careful of excess water spilling from the water reservoir.

Unplug the unit from the outlet when not in use, when moving unit from one location to another or before cleaning.

Please pull plug out when filling water or cleaning appliance. Don't connect to the power before you complete.

Do not operate the unit with a damaged cord & plug. Do not use extension cords in order to avoid overheating and risk of fire.

No detergent can be added into the water tank or it will cause damage.

Distilled or demineralized water is recommended.

Service life – 4 years.

WARNING

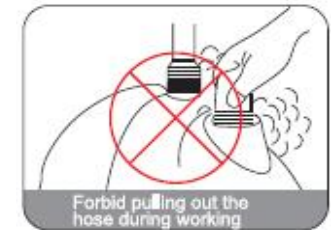

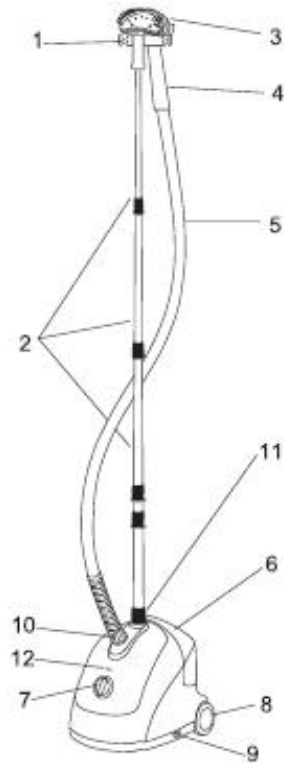

COMPONENTS

1. Hanger
2. Telescopic Pole
3. Steam spout
4. Handle
5. Hose
6. Water Tank
7. Switch
8. Rolling Casters
9. Drain Plug
10. Hose Nut
11. Pole Nut
12. Indicating Lamps
13. Pants Clamp
14. Fabric Brush
15. Folding rack (Optional)

4 power programs:

- 1 - for silk,
- 2 - for polyester,
- 3 - for cotton
- 4 - for linen



INSTALLATION INSTRUCTIONS

Due to some parts hidden in foam outside, please check the two sides of packaging materials carefully.

1. Insert the telescopic pole to the pole base (A).
2. Put the hose into the hose base and tighten the hose by turning the hose nut clockwise (B).
3. Hang the Steam Spout on the steam hanger (C).

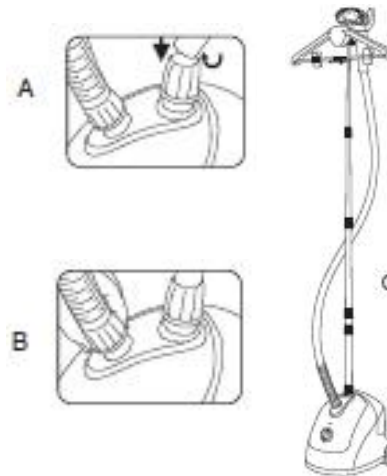

CAUTION

1. Always hang the Steam spout on the steam hanger when the appliance is not in use to prevent hose from being folded and damaged.
2. The telescopic pole must be fully extended during steam operation to ensure smooth hose and provide free flow of steam.

3. Do not pull the hose with excessive force otherwise will damage hose and lead to steam leakage, Do not move the appliance by grasping the hose.

PRESSING WITH STEAM

Press downward for a longer time on the garment collar flank with spout when steaming. Steam it back and forth from the top to bottom; refer A and B;



A



B

Straighten the garment sleeve when steaming, press for a moment on the sleeve flanging with spout. Please refer C;



C

Steam clothes and bottom of clothes. Please handle bottom side. Refer D.



D

ACCESSORY ASSEMBLY

The garment steamer comes with a practical accessory, Fabric Brush, to attach this accessory to the Steam spout:

1. Turn off the steamer and wait until no steam emits from the Steam spout.

2. Fabric brush's pegs aim and insert the holes on the Steam spout. See Figure 5.

3. Push the brush and firm it in place.

CAUTION:
Do not install the accessory while steam emitting from the Steam spout and avoid burns.

Figure 5

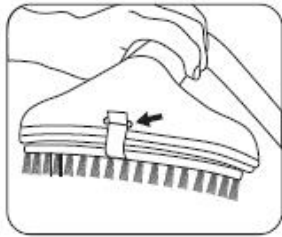

INSTRUCTIONS FOR USE

1. Unplug the Power Cord, and turn the Switch to the "Off" or "0" position.

2. Remove the Water Tank, turn it upside down, and unscrew the Valve Cap. Fill the Water Tank with cool water, and replace the Valve Cap. Hot water is forbidden. To prolong the lifetime of your steamer, we recommend using distilled or demineralized water. Place the water tank back into the unit and make sure it is sitting properly and securely in the flume. Do not let the steamer working with a dry water tank or else you can damage the unit.

3. Plug the unit into an electrical outlet.

4. Turn on the Switch. Verify that the light is on the switch. Steam should start flowing from the spout in approximately 45 seconds.

5. Please select an appropriate programs (1,2,3 or 4) according to different materials of the clothes for better ironing performance. We suggest:

Program 1 for silk program 2 for polyester. Program 3 for cotton and program 4 for linen.(this function Only for 4 powers program models).

6. When you finish your steam iron, turn the switch on the "Off" or "0" position and pull plug out from the outlet.

INSTALL PARTS

Pants clamp installation:

Lean the pants clamp, let flute corner towards on the fix-panel of steam nozzle, and clip pants clamp gently

through the corner, pants clamp can be fixed on steam spout.

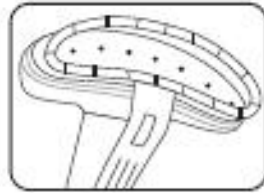

Folding rack installation (Optional Parts):

1. Take out folding racket, pull out pin(A);

2. Ensure hole of hanger aim on the folding rack hole(B), put the pin(A) through the hole. Fix the hanger and folding rack;

3. Pull and open the folding rack, push bar(C) from left to right and fix the crossbar (C);

4. When finish Ironing, push Bar(C) from right to left and fold rack.

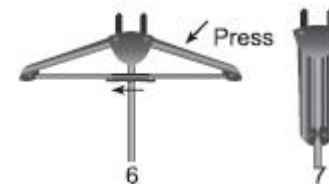
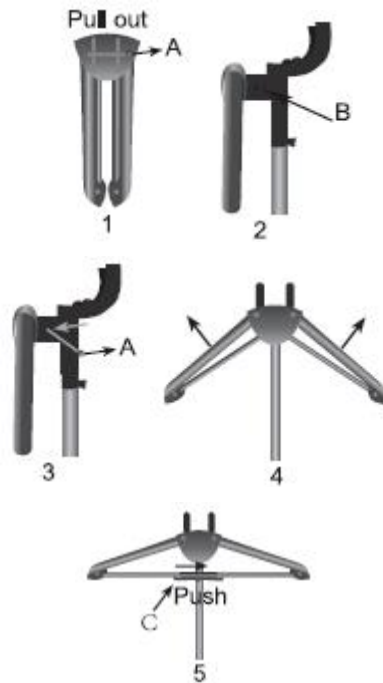

IRON THE TROUSERS SEAM

In order to iron the trousers seam straight and smooth when using our garment steamer, please use the pants clamp. Make the connection to be open between the spout and pants clamp, grip the pants clamp and iron the trousers seam vertically, then trousers seam can be very straight and smooth. Also you can use Mini ironing board at the back side and spout at front side, it will be easy and fast also for ironing trousers and pants.

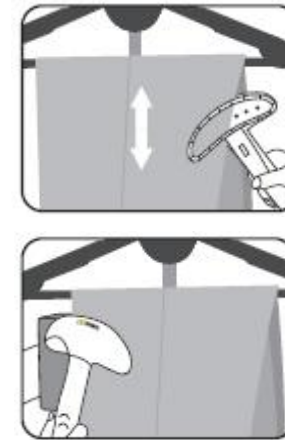

CLEANING AND STORAGE

We recommend you follow this procedure at least once per month to extend machine working periods;

1. Turn the Switch to "off" or "0" position.

2. Unplug the unit from the power outlet.

3. Ensure the steamer to cool for at least 30 minutes.

4. Remove the Hose and shorten the Telescopic Pole, then set them aside.

5. Remove and drain the Water Tank. Rinse the water tank with fresh water, and drain completely.

6. Drain the steamer by removing the Drain Plug and emptying the contents. Picture A.



A

7. Flush the unit by filling the Water flume and the Hose Connector with fresh water and draining completely. Put the Drain Plug back.

8. Wrap the Hose around the Telescopic Pole one time. Place the Steam spout on the steam hanger. 9. Store in a cool and dry place.

REMOVING MINERAL DEPOSIT

Impure water containing mineral or sediment may cause mineral deposit leaving in the steamer, which will affect the free flow of steamer. To reduce the occurrence of mineral deposit in the steamer, demineralized or distilled water is recommended. To remove the mineral deposit, please follow below procedure:

1. Turn the unit off, and unplug the power cord.

2. Remove the hose and pole from the unit.

3. Drain the Water flume and empty water from the Water Tank.

4. Mix a solution of 50% vinegar and 50%wateror Citric acid.

5. Slowly pour the water-vinegar or citric acid into the Hose Connector or water tank about 0.6 Liters;

6. Let the unit power on and work for 5-6 minutes.

7. Cool the unit for about 30 minutes, drain the solution out of the Water Reservoir by removing the drain plug and allowing the liquid to drain into a sink or tub.

8. Drain the solution out of the Hose Connector by tilting the unit over a sink or tub and pouring the water out of the Hose Connector.

9. Pour clean water in the Hose Connector or Water flume inlet and drain it. Repeat this step until the vinegar odor dissipates.

10. Reassemble the unit and operate normally.

IF THIS PROCEDURE DOES NOT RETURN THE UNIT TO NORMAL OPERATION, THE UNIT MAY NEED SERVICING.

TROUBLE TREATMENTS

Problem	Reason	Solution
Unit fails to steam. Indicating Lamps does not come on.	Steamer is not plugged in	Plug into electrical outlet
	Household circuit breaker is broken	Reset the circuit outlet or contact a qualified electrician
Unit fails to steam. Indicating lamps comes on	Have Mineral deposit in the unit	Follow the Removing Mineral Deposit procedure to remove the sediments
	The Water Tank is empty	Refill the Water Tank
Excessive "gurgle" on Hose and Steam spout	Condensation in hose	"Gurgle" is normal during the steam process. During excessive gurgling, extend the hose to allow excess water back into the water flume
Steam is intermittent	Mineral deposit in the unit	It's normal for the unit to periodically stop steaming for a few seconds. If the steam stays off for longer periods, follow the removing mineral deposit procedure

SPECIFICATIONS

Power: 1750 W
 Rated voltage: 220-240 V
 Rated frequency: 50 Hz
 Rated current: 7.9 A

RU

"Saturn".

SET

- STEAM IRON 1
- BRUSH 1
- PANTS CLAMP 1
- FOLDING RACK 1
- CLIPS 2
- IRONING MINI BOARD 1
- INSTRUCTION MANUAL WITH WARRANTY BOOK 1
- PACKAGE 1

ENVIRONMENT FRIENDLY DISPOSAL

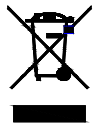

You can help protect the environment! Please remember to respect the local regulations: hand in the non-working electrical equipment to an appropriate waste disposal center.

1,5

The manufacturer reserves the right to change the specification and design of goods.

1,5

30

- 4



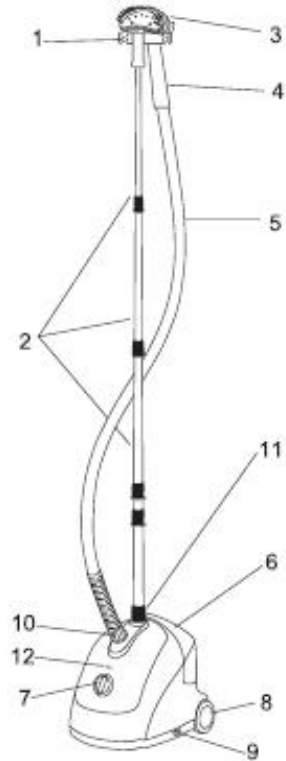

- 1.
- 2.
- 3.
- 4.
- 5.
- 6.
- 7.
- 8.
- 9.
- 10.
- 11.
- 12.
- 13.
- 14.
- 15.

- 1 -
- 2 -
- 3 -
- 4 -



- 1.
- 2.
- 3.

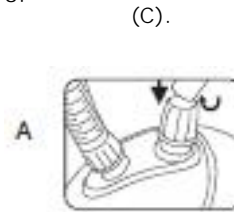

- 1.
- 2.

3.

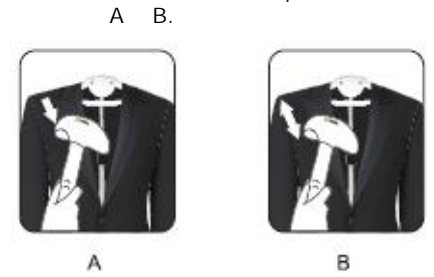

(A).

(B).

(C).

C.



D.



1.

2.

5.

Рисунок 5

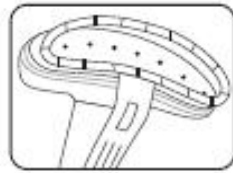
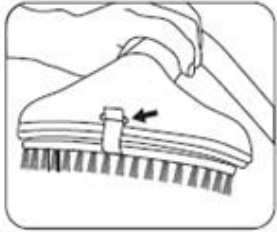

1.

2.

):

(A).

(B),
(A).

3.

(C)

(C):

4.

(C)

Вытянуть



1

2



3

4

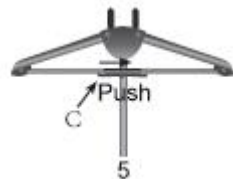

5

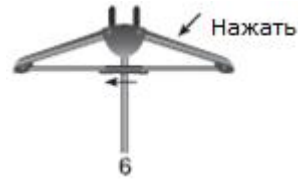

6

7



A

7.

8.

9.

3.

1.

2.

"Off" "0".

3.

4.

45

(1, 2, 3

4)

1 -
2 -
3 -
4 -

6.

"Off" "0"

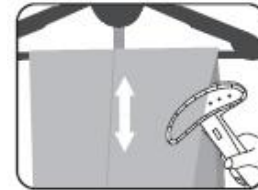

1.

2.

3.

4.

5.

0,6).

6.

7.

30

8.

9.

10.

1:1

(

5-6

1.

2.

3.

4.

5.

6.

"Off" "0".

30

A.

		» «
		« »

U

1750
:220-240
50
7,9

"Saturn".

1
1
1
1
2
1

1
1



1,5

1,5

30

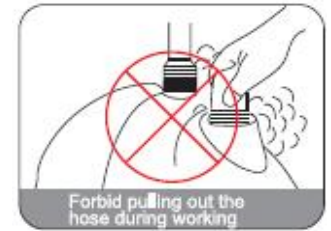
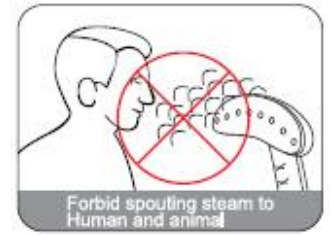

- 4

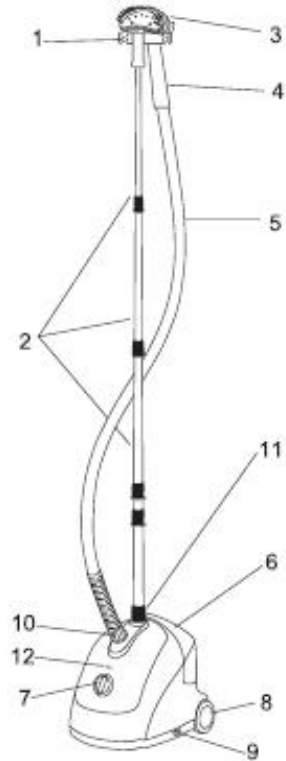

- 1.
- 2.
- 3.
- 4.
- 5.
- 6.
- 7.
- 8.
- 9.
- 10.
- 11.
- 12.
- 13.
- 14.
- 15.

- 1 -
- 2 -
- 3 -
- 4 -



- 1.
- 2.
- 3.

(A).

(C).



- 1.
- 2.

(B).



3.

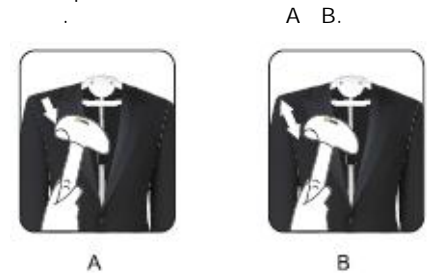

C.



D.



1.

2.

5.

Малюнок 5

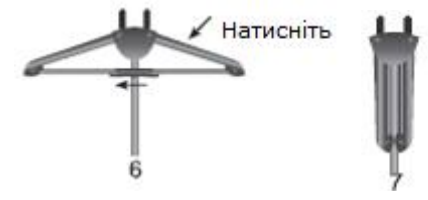
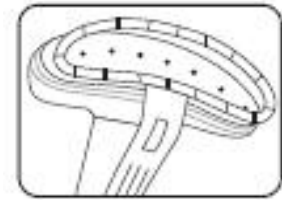
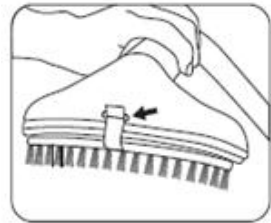

A

- 1.):
- 2. (A).
- 3. (B), (A).
- 4. (C) (C):
- 5. (C)

- 7.
- 8.
- 9.

3.

1.

"Off" "0".

2.

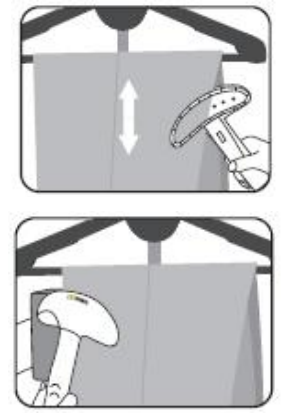

- 1.
- 2.
- 3.
- 4. 1:1
- 5.
- 6. (0.6).
- 7. 5-6 30

3.

4.

45

(1, 2, 3 4)

1 -

3 - 2

4 -

6.

"0"

"Off"

- 1. "Off" "0".
- 2.
- 3. 30
- 4.
- 5.
- 6.

- 8.
- 9.
- 10.

A.

		».
		«
		«
		».

Saturn®

INTERNATIONAL MANUFACTURER'S WARRANTY

,

MEZINÁRODNÍ ZÁRUKA

: 1750
: 220-240
: 50
: 7,9

1
1
1
1
2
1

1
1

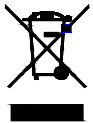

INTERNATIONAL MANUFACTURER'S WARRANTY

The Warranty is provided for the period of 2 years or more if the Law on User Right of the country where the appliance was bought provides for a greater minimum warranty period.

All terms of warranty comply with to the Law on Protection of the Consumer Rights and are governed by the legislation of the country where the product was bought. The warranty and free of charge repair are provided in any country where the product is delivered to by Saturn Home Appliances or authorized representative thereof, and where no restriction of import or other legal provisions interfere with rendering of warranty services and free of charge repair.

Cases uncovered by the warranty and free of charge repair:

1. Guarantee coupon is filled in improperly.
2. The product has become inoperable because of the Buyer's nonobservance of the service regulations indicated in the instruction.
3. The product was used for professional, commercial or industrial purposes (except for the models, specially intended for this purpose that is indicated in the instruction).
4. The product has external mechanical damage or damage caused by penetration of the liquid inside, dust, insects and other foreign objects.
5. The product has damages caused by non-observance of the rules of power supply from batteries, mains or accumulators.
6. The product was exposed to opening, repair or modification of design by the persons, unauthorized to repair; independent cleaning of internal mechanisms etc. was made.
7. The product has natural wear of parts with limited service life, expendables etc.
8. The product has deposits of scale inside or outside of fire-bar elements, irrespective of used water quality.
9. The product has damages caused by effect of high (low) temperatures or fire on non-heat resistant parts of the product.
10. The product has damages of accessories and nozzles which are included into the complete set of product shipment (filters, grids, bags, flasks, cups, covers, knives, sealing rings, graters, disks, plates, tubes, hoses, brushes, and also power cords, headphone cords etc.).
11. A defect was a result of inappropriate installing of the appliance by non-specialists of the supplier's authorized service center.

On the warranty service and repair, please contact the authorized service centers of "Saturn Home Appliances".

MEZINÁRODNÍ ZÁRUKA

Záruka se poskytuje na dobu 2 roky. V případě že Zákon na ochranu spotřebitele dané země nařizuje delší dobu, prodlužuje se záruka na tuto dobu.

Veškeré záruční podmínky odpovídají Zákonu o ochraně práv uživatelů a jsou řízené zákonodárstvím státu, kde byl výrobek koupen.

Záruka a bezplatná oprava se poskytují v každém státě, kam jsou výrobky dodané společností „Saturn Home Appliances“ nebo jejím zplnomocněným zástupcem a kde nejsou žádná omezení na dovoz nebo jiné právní předpisy omezující poskytnutí záručního servisu a bezplatné opravy.

Případy, na které se záruka a bezplatná oprava nevztahují

1. Záruční list je vyplněn nesprávně.
2. Výrobek byl poškozen kvůli tomu, že zákazník nesplnil pravidla použití, která jsou uvedena v návodu.
3. Výrobek byl používán k profesionálním, komerčním nebo průmyslovým účelům (kromě modelů speciálně určených pro tyto účely, což je uvedeno v návodu).
4. Výrobek má vážnější mechanická poškození nebo poškození, vyvolaná tím, že se dovnitř dostala tekutina, prach, hmyz a jiné cizí předměty.
5. Výrobek má poškození, která jsou vyvolaná nesplněním pravidel napájení od baterií, sítě nebo akumulátorů.
6. Výrobek rozebírali, opravovali nebo měnili jeho konstrukci lidé, kteří nebyli zplnomocněni k opravě, bylo provedeno samostatné čištění vnitřních mechanismů a pod.
7. Výrobek má prokázané opotřebení dílů s omezenou dobou použití, spotřebních materiálů atd.
8. Výrobek má vrstvu usazeniny uvnitř nebo zvenku termoelektrických ohřevů, bez ohledu na kvalitu používané vody.
9. Výrobek má poškození, která jsou vyvolána působením vysokých (nízkých) teplot nebo ohněm na termonestabilní části výrobku.
10. Výrobek má poškozené příslušenství a nástavce, které jsou dodané spolu s výrobkem (filtry, sícky, sádky, bafly, mísy, víka, nože, šlehače, struhadla, kotouče, talíře, trubky, hadice, kartáče a také síťové šňůry, sluchátkové šňůry atd.).
11. Vada je důsledkem nesprávné instalace výrobku neoprávněnou osobou.

V otázkách záručního servisu a oprav se obraťte na autorizovanou servisní středisko společnosti „Saturn Home Appliances“.

«Saturn Home Appliances»

- 1.
- 2.
- 3.
- 4.
- 5.
- 6.
- 7.
- 8.
- 9.
- 10.
- 11.

« Saturn Home

Appliances» .

: <http://saturn.ua/ru/servis>,
: 0-800 505-27-09

					LCD		
, 4	« C »	8 (988) 993-37-78	+		+	+	+
, 18		8 (8553) 32-22-11 8 (960) 047-22-11	+	+	+	+	+
, 98	« » -	8 (86133) 6-09-84, 8(918) 215-57-75	+	+	+	+	+
, 109	-	8 (86152) 2-81-99	+	+	+	+	+
, 1, 1, 12	« -29»	8 (8182) 44-15-55	+				
, 47	« »	8 (8512) 25-19-39, 8 (8512) 25-12-00	+	+	+		
, 54	" - "	8 (8512) 50-19-97	+		+		
2, 16, 7	« »	8 (8512) 54-67-67, 8 (8512) 54-91-91		+		+	+
15	« »	8 (85141) 3-61-25	+	+	+	+	+
, 32		8 (927) 552-47-21, 8 (937) 122-13-99				+	+
113	« »	8 (3852) 63-94-02	+		+	+	+
, 9, 25		8 (905) 425-60-4-73	+	+	+		
37		8 (8635) 47-47-72	+	+	+	+	+
, 63	« »	8 (86155) 3-11-00, 8 (918) 980-64-75	+	+	+	+	+
, 18	" - "	8 (3535) 23-23-98, 8-922-802-21-58	+	+	+	+	+

		8 (86559) 2-08-02, 8 (86559) 5-29-71	+	+	+	+	+
36	« » -	8 (3955) 67-00-44, 8(3955) 56-61-93	+	+	+	+	+
	« »	8(4832) 63-06-00, 8 (4832) 33-15-61		+			
	« »	8 (8442) 97-50-10, 8 (960) 883-59-00		+			
		8 (8442) 98-16-47, 8 (8442) 53-06-04	+	+	+	+	+
11	« » -	8 (8442) 37-16-74, 8 (8442) 37-69-03		+			
	« »	8 (961) 688-53-48		+			
		8 (927) 521-52-00		+		+	+
32		8 (937) 722-68-12				+	+
		8 (937) 730-66-03		+		+	+
		8 (904) 404-14-55				+	+
C 12/15	«Master»	8 (928) 126-63-66	+		+		
	«X »	8(8639) 27-80-47	+	+	+	+	+
77-	« »	8 (937) 717-93-36	+		+		
	« »	8 (8172) 70-03-45, 8 (8172) 54-21-54	+		+	+	+
	« »	8 (8172) 52-72-51	+		+		

46	« »	8 (473) 260-09-08, 8 (473) 240-57-73	+		+	+	
	« »	8 (38822) 6-23-32	+		+	+	+
	« »	8 (962) 655-20-00	+	+	+	+	+
	« »	8 (8313) 21-14-14	+		+		
	« »	8(8313) 20-56-00	+	+	+	+	
63	« »	8 (84235) 2-86-59, 8 (84235) 9-14-64	+		+	+	+
	« - »	8 (86132) 2-11-71, 8 (86132), 3-66-02	+	+	+	+	+
	« »	8(86132)5-05-00	+	+		+	+
	« »	8 (343) 240-26-60	+		+		
7	«GOLD»	8-919-372-28-4			+		+
	« - »	8(3955) 67-00-44, 8 (3955) 56-61-118	+		+	+	+
		8(86359) 4-32-23, 8 (86359) 4-06-42			+		
47	« »	8 (47467) 4-12-08, 8 (47467) 4-33-17	+		+		
45/6	« » -	8 (4932) 335185, 8 (4932) 335236	+	+	+	+	+
	« - »	8 (3412) 30 79-79, 8 (3412)30-83-07	+		+	+	+
	« - »	8 (3412) 78-76-85, 8 (3412) 78-06-64	+		+	+	+
	« - »	8 (3412) 44-60-40, 8 (3412) 44-60-67			+		
	« » 7 « 26»	8 (86545) 2-74-74			+		

24	« »	8 (8362) 24-11-24, 8(8362) 25-55-40	+	+	+	+		
24	« »	8 (3952) 42-55-76 8 (3952) 78-15-83	+		+	+		
56	« »	8 (3952) 28-74-50, 8 (3952) 76-71-75		+		+	+	
183	« »	8 (34551) 7-46-31						+
33	-	8 (3439) 39-95-20, 8 (34399) 34-74-40	+	+	+	+	+	
6	« »	8 (84457) 9-17-43, 8 (84457) 9-45-89	+	+	+	+	+	
157		8 (8734) 44-42-44	+	+		+	+	
53/2	-	8 (3842) 35-39-67	+			+		
17	« »	8 (87239) 2-33-55, 8 (87239) 3-01-77	+	+	+	+	+	
42	« - »	8 (8332) 56-25-95, 8 (8332) 54-70-77	+		+	+		
9	-	8 (988) 548-24-36	+		+			
9	-	8-928-172-52-26		+				
2		8 (86142) 4-43-59	+	+	+	+	+	
1	« »	8-918-936-36-53		+		+	+	
3	-	8(861) 267-50-88	+	+	+	+	+	
55	« - »	8 (861) 222-64-13, 8 (861) 222-85-55, 8 (905) 408-08-38	+	+	+	+	+	

106	« »	8 (86156) 3-40-40, 8-918-990-35-04	+		+	+		
42/2		8 (918) 041-31-04, 8(86131) 71-2-72			+			+
116		8 (86164) 7-01-22			+			
57	« »	8 (86145) 3-78-74			+			+
25	« »	8 (86164) 65-4-95, 8-918-355-81-70	+	+			+	+
1		8 (86153) 4-16-70			+			
168	« - »	8 (86151) 4-33-54, 8 (918) 464-00-86	+	+			+	+
6	« »	8 (3912) 92-92-22, 8 (3912) 41-78-88	+	+	+	+	+	
1	« »	8 (3912) 93-54-33, 8 (3912) 94-52-82	+	+	+	+	+	
36 37	« + »	8 (4712) 50-85-90, 8 (4712) 35-04-91	+	+	+	+		
2	« »	8 (86169) 7-39-99, 8 (86169) 7-24-96	+	+	+	+	+	
66	« »	8 (4742) 33-45-65, 8 (4742) 33-45-95	+	+	+	+	+	
25	« »	8 (8772) 55-62-38	+	+	+	+	+	

20	« »	8 (8722) 93-30-73	+	+	+	+	+
11	« »	8 (86385) 2-33-26, 8 (960) 458-07-11	+	+		+	+
9	«X »	8-909-401-35-21	+	+	+	+	+
1534	« »	8 (499) 717-82-07, 8 (499) 717-82-12	+		+	+	+
3	« »	8 (495) 721-30-70, 8 (499) 168-05-19, 8 (499) 168-47-15	+		+	+	+
20 (30/05)	« »	8 (8552) 35-90-02, 8 (8522) 35-90-42	+	+	+	+	+
24	« »	8 (8662) 42-04-30, 8 (8662) 42-12-21	+		+	+	
55	« »	8 (86554) 5-59-77, 8 (86554) 3-67-57	+	+	+	+	+
10	« »	8 (34783) 3-43-44	+	+	+	+	+
9 (« »)	« »	8 (8555) 48-08-80, 8-917-906-60-06	+		+	+	+
18	« »	8 (831) 46-18-848		+			+
6		8 (831) 46-18-848		+			+
18	« »	8 (3843) 20-31-33	+		+	+	+
21/27	« »	8 (48762) 6-46-46	+	+	+	+	+
14	« »	8 (8617) 6311-15, 8 (8617) 63-03-95	+	+	+	+	+
17	« - »	8 (383) 274-99-33, 8 (383) 274-99-45	+		+		

3	« »	8 (383) 210-59-49, 8 (383) 210-52-92	+		+	+	
24		8 (86369) 3-74-75, 8 (928) 609-35-85	+	+	+		
4		8 (3532) 36-87-94	+			+	+
194	« »	8 (3812) 36-74-01					+
130	« »	8 (3812) 36-42-02	+	+	+	+	
2	« »	8 (3537) 33-84-43, 8 (3537) 35-13-18	+	+	+	+	+
11	« »	8 (3537) 35-79-93	+	+	+	+	+
2	« »	8 (8412) 26-09-60, 8 (8412) 26-12-29	+			+	+
3	« »	8 (342) 221-40-99	+	+	+	+	+
11	« »	8 (342) 240-93-35, 8 (342) 240-93-24		+			
11	« »	8 (8142) 78-06-93, 8 (8142) 70-65-48	+			+	
39-5		8 (3846) 69-33-00	+	+	+	+	+
11	« »	8 (8112)-53-86-30, 8 (8112) 53-86-50	+			+	
12		8-928-225-95-85		+		+	+
5-3	« »	8 (8793) 98-70-11	+	+	+	+	+
50		8 (47396) 48-911	+	+	+	+	+
37	« »	8 (863) 250-47-77	+			+	
7	« »	8 (863) 227-60-90, 8 (863) 299-00-50	+	+	+	+	+

50- 1/52, 55	« »	8 (863) 21-92-112, 8-800-100-51-52	+	+	+	+	+
17 11 /		8 (906) 453-35-81	+		+		
12	« - »	8 (4855) 22-04-77, 8 (4855) 25-38-60	+	+	+	+	+
14	« »	8 (86370) 2-19-50	+	+	+	+	+
12	« »	8 (4855) 22-04-77, 8 (4855) 25-38-60	+	+	+	+	+
21	« »	8 (4855) 24-31-21	+	+	+	+	+
14, 1	« - »	8 (4912) 76-88-01, 8 (4912) 40-30-30	+	+	+	+	+
42	« - »	8 (4912) 41-33-02	+	+	+	+	+
100/ 56	« - »	8 (846) 990-37-51, 8 (846) 240-98-17	+		+	+	+
e 197	« XXI» -	8 (812) 600-11-97	+	+	+	+	
e 41,	« - »	8 (812) 325-36-56, 8 (812) 325-36-57	+		+	+	
e 11, 36	95» « -	8 (812) 822-18-00, 8 (812) 320-06-61	+				
1	« - »	8 (8342) 23-05-91, 8 (8342) 47-48-59	+	+	+		
95	« - »	8 (8452) 52-81-21, 8 (8452) 52-83-84	+	+	+	+	+
167/1		8 (951)-522-38-11	+	+	+	+	+

253	« »	8 (496) 547-04-95, 8 (496) 549-32-79	+	+		+	+
7	" -S"	8-963-624-49-46				+	+
44	« »	8 (4812) 45-05-13, 8-920-333-09-44	+	+	+	+	+
90	« »	8 (8622) 55-51-19, 8 (8622) 55-01-08	+			+	+
63	« »	8 (8652) 24-30-14, 8 (8652) 23-31-81	+	+	+	+	+
15, 21	« »	8 (8652) 95-53-68, 8 (8652) 95-61-90				+	
1	« - »	8 (4725) 24-62-27, 8 (4725) 24-73-49	+	+	+		
158	« - »	8 (3473) 20-12-13, 8 (3473) 20-27-70	+			+	+
25	« »	8 (8212) 22-95-29, 8 (8212) 29-12-20	+	+	+	+	+
137	2000» « -	8 (4752) 56-19-42, 8 (4752) 56-19-44	+	+	+	+	+
24/2		8 (86130) 4-86-59, 8-(918) 147-02-03	+	+		+	+
2/2	« - »	8 (86196) 7-20-53	+	+	+	+	+
48	« +»	8 (8482) 22-72-41, 8 (8482) 22-71-85, 8 (8482) 61-65-64	+	+	+	+	+
58	« -2»	8 (3822) 56-23-35, 8 (3822) 48-08-80	+			+	

137	« - »	8 (4872) 31-12-57	+	+	+	+	+
55	« »	8 (3452) 47-35-69	+		+	+	+
28	« »	8 (3012) 21-89-63	+		+	+	+
16/7	« - »	8 (8422) 73-44-22, 8 (8422) 73-29-19	+	+		+	+
378	« - »	8 (87875) 7-44-82	+	+	+	+	+
6/1	« - »	8 (347) 236-57-07	+		+		
148	« »	8 (3472) 77-12-62	+		+		
153, 42, 7	« »	8 (347) 279-90-70, 8 (347) 241-62-02					+
15	« - »	8 (86391) 2-18-06	+		+		
36	« »	8 (8352) 62-30-97, 8 (4942) 63-20-98	+		+		
8	-	8 (351) 239-39-34, 8 (351) 239-39-35	+	+	+	+	+
18	« »	8 (8202) 54-31-88	+		+	+	+
340 « »	« - »	8 (8782) 27-30-60, 8 (8782) 27-70-77	+	+	+	+	+
48, 11	« . . »	8 (8782) 25-04-66, 8 (8782) 25-19-15	+	+	+	+	+
33	« » -	8 (3022) 36-39-36, 8 (3022) 36-39-32	+	+	+	+	+
1		8 (904)-345-83-18	+	+	+	+	+

3- 21	« »	8 (84722) 9-52-07, 8 (937) 469-52-07	+	+	+	+	+
57	« - »	8 (8453) 55-80-89, 8 (964) 848-45-06	+		+	+	+
12	« - »	8 (4852) 25-94-83	+		+		

UA

- 2
- «Saturn Home Appliances»
- 1.
 - 2.
 - 3.
 - 4.
 - 5.
 - 6.
 - 7.
 - 8.
 - 9.
 - 10.
 - 11.

« Saturn Home Appliances» .

: <http://saturn.ua>,

0-800 502-502

, 36	(06442)-91137, 0990521001	Hi-Fi ()	+	+	+	+	+	-	+	
, 42	(06274)-49128, 0627449129	-	+	+	+	+	+	-	+	
50- 82	(04563)-68413	-	+	+	+	+	+	-	+	
28	(0456)-333295, (0456)-309400, 094-9299400	-	-	+	+	+	+	-	-	
, 57	(04143)-40636	" "	+	+	+	-	+	+	+	
, 43	(03141)-43432	" "	+	+	+	+	-	-	-	
, 50 , 51	(0432)-699573		+	+	+	+	+	+	+	
, 3	(0432)-642457, (0432)-642622		-	+	+	-	-	-	-	
, 1	(0432)-509191, (0432)-579191, 066-3509191 096-0509191	-	+	+	+	+	+	-	+	
, 16	(0432)-464393, (0432)-468213, (0432)-519254	-	+	+	+	+	+	+	+	
, 43	067-7899525	-	+	+	+	-	-	-	-	
, 62-	(05653)-52771		+	+	+	+	+	+	+	
, 59	(0562)-350409, (0562)-346705		+	+	+	+	+	-	+	
6	(056)-7356328, (056)-7356325	-	+	+	+	+	+	-	+	

, 46-	(056)-7854002, 067-5071964	-	-	+	+	+	+	+	-	
, 41-	(056)-7900460	-	+	+	+	+	+	-	+	
129-	066-2493639	-	+	+	+	-	-	-	+	
, 1	066- 5082652, 096-7232447	-	+	+	+	+	+	+	+	
, 188	(062)-3450607	-	+	+	+	+	+	-	+	
, 24	(0412)-470742	C ()	-	-	+	+	+	-	-	
, 8	(0412)-471568, 067-4115812	(")	+	+	+	-	-	-	+	
, 175	(061)-7875051, (0612)-639790		+	+	+	+	+	+	+	
, 83	(0612)-120303	-	+	+	+	+	-	-	+	
, 50	(061)-2209764, (061)-2209765	-	+	+	+	+	+	-	+	
223	(0342)-756040, (0342)-712813		+	+	+	+	+	-	-	
, 19-	(0342)-559525, (0342)-750777		+	+	+	+	-	-	-	
, 2	067-3248218	" "	+	+	+	+	+	+	+	
76	(04597)-57393	" "	+	+	+	-	-	-	-	
, 161	067-3248401, 067-3248365, (04736)-62949	« - »	+	+	+	+	+	+	+	
, 16	(044)-4269198, (044)-3629198	" "	+	+	-	-	-	-	+	
, 55	(044)-3641463, (044)-4086660, (044)-4972936,	-	-	+	+	+	+	+	-	

	(044)-4973455, (044)-4973619, (044)-4086658, (044)-4086659																			
1-	(044)-5911190	" "	+	+	+	+	+	+	+	+	+	+	+	+	+	+	+	+	+	+
.15	(06561)-62102, 096-3852181		+	+	+	-	-	-	-	-	-	-	-	-	-	-	-	-	-	-
,2	(0522)-357923, (0522)-278002, (0522)-273300		+	+	+	+	+	+	+	+	+	+	+	+	+	+	+	+	+	+
,1-	(0522)-272840, (0522)-277667	()	+	+	+	+	+	+	+	+	+	+	+	+	+	+	+	+	+	+
,13	097-7766770 097-2642167		+	+	+	+	+	+	+	+	+	+	+	+	+	+	+	+	+	+
10	(06272)-26223, (06272)-22186, 050-2796816	()	+	+	+	-	-	-	-	-	-	-	-	-	-	-	-	-	-	-
2-	(04142)-50504	" "	-	+	+	+	+	+	+	+	+	+	+	+	+	+	+	+	+	+
,7	050-5260668		+	+	+	+	+	+	+	+	+	+	+	+	+	+	+	+	+	+
3	(06264)-59389		+	+	+	+	+	+	+	+	+	+	+	+	+	+	+	+	+	+
8 .20	050-9732014		+	+	+	+	+	+	+	+	+	+	+	+	+	+	+	+	+	+
,5-	(0626)-412134, 067-2557990		+	+	+	+	+	+	+	+	+	+	+	+	+	+	+	+	+	+
,44, 2	(05366)-39192		+	+	+	+	+	+	+	+	+	+	+	+	+	+	+	+	+	+
,42	(056)-4013356, (056)-4040080, (056)-4746103	" -"	+	+	+	-	+	+	+	+	+	+	+	+	+	+	+	+	+	+
73	(056)-4400764	" "	+	+	+	+	+	+	+	+	+	+	+	+	+	+	+	+	+	+
,64/7	(056)-4400779		+	+	+	+	+	+	+	+	+	+	+	+	+	+	+	+	+	+

,9	(056)-4092302, (056)-4092303	(-)	+	+	+	+	+	+	+	+	+	+	+	+	+	+	+	+	+	+
,81	050-2149173, 066-017-02-03		+	+	+	+	+	+	+	+	+	+	+	+	+	+	+	+	+	+
96-	(0642)-330242, (0642)-331186, 095-3868985	" "	+	+	+	+	+	+	+	+	+	+	+	+	+	+	+	+	+	+
49-	(0642)-505783, 095-3624248		+	+	+	+	+	+	+	+	+	+	+	+	+	+	+	+	+	+
,61	066-0640564, 050-5809230		-	-	-	+	-	-	-	-	-	-	-	-	-	-	-	-	-	-
,1	(06434)-26025, 099-2710147		+	+	+	+	+	+	+	+	+	+	+	+	+	+	+	+	+	+
,1	(0332)-290752	" -"	+	+	+	-	-	-	-	-	-	-	-	-	-	-	-	-	-	-
,15-	(0332)-779955, 097-0482596		+	+	+	+	+	+	+	+	+	+	+	+	+	+	+	+	+	+
15-	(032)-2445340, (032)-2445344		+	+	+	+	+	+	+	+	+	+	+	+	+	+	+	+	+	+
,2	(032)-2471499		+	+	+	-	-	-	-	-	-	-	-	-	-	-	-	-	-	-
28	(032)-2395152, (032)-2395577, (032)-2955028, (032)-2955029	" -"	+	+	+	+	+	+	+	+	+	+	+	+	+	+	+	+	+	+
116	(032)-2458052	" -"	+	+	+	-	-	-	-	-	-	-	-	-	-	-	-	-	-	-
,242	(0623)-225550, 066-1032288, 097-7768120		+	+	+	-	-	-	-	-	-	-	-	-	-	-	-	-	-	-
.50- ,32\18	(0629)-496005, (0629)-493006		+	+	+	+	+	+	+	+	+	+	+	+	+	+	+	+	+	+
227	(0629)-473000, 098- 3122628,	" -"	+	+	+	+	+	+	+	+	+	+	+	+	+	+	+	+	+	+

	095-0282628 (0629)-491881,	()																		
84	067-5975615		+	+	+	+	+	-	+											
	(0619)-444400	()	-	+	+	+	+	+	+											
51-	(04337)-64847, (0432)-468213		+	+	+	+	+	+	+											
	(03131)-37337, (03131)-37336, 099-7974430, 097-3423551		+	+	+	-	+	+	-											
	(0512)-470496, (0512)-478348	" "	+	+	+	+	+	+	+											
	(0512)-580647		+	+	+	+	+	+	-											
	(0512)-582180, 067- 5170570, 066-7056444	" "	-	+	+	+	+	+	-											
	(05662)-41503, 099-0743553	" - - "	+	+	+	+	+	+	+											
	(0566)-688563, 050-5800296	()	+	+	+	+	+	+	+											
	(0566)-687014		-	+	+	+	+	+	+											
	095-7247266		+	+	+	+	+	+	-											
	(04141)-52010	" "	+	+	+	+	+	-	+											
	(048)-7001737 (048)-7874579		+	+	+	+	+	+	+											
55	(0482)-390618, 094-8390619		+	+	+	+	+	-	+											

	, 27	(048)-7229779 (048)-7712538, (048)-7227066	-	-	+	+	+	+	+	+	+	+	+	+	+	+	+	+	+	+
2 (66)	(048)-7317703, (048)-7317704			+	+	+	-	-	-	-	+								
172-		(05632)-61554, (05632)-62342			+	+	+	+	+	-	+									
75		096-2840836, 066-0857539	-	-	+	+	+	+	+	+	+	+	+	+	+	+	+	+	+	+
	, 29	(0532)-694262, 099-601424			+	+	+	+	+	+	+	+	+	+	+	+	+	+	+	+
	, 120	(0532)-509889, 050-0137217			+	+	+	+	+	+	+	+	+	+	-	+				
	, 66	(0532)-615621	-	-	+	+	+	+	+	+	+	+	+	+	+	+	+	+	+	+
	, 64	099-4243675	-	-	+	+	+	+	+	+	+	+	+	+	+	+	+	+	+	+
	, 101/1	(04637)-38595, 095-8862199, 063-5974127, 067-2725751	-	-	+	+	+	+	+	+	+	+	+	+	+	+	+	+	+	+
	, 12	(0362)-266585	-	-	+	+	+	+	+	+	+	+	+	+	-	+				
	, 55	(0362)-436452, (0362)-635489, 067-2385635	-	-	+	+	+	+	+	+	+	+	+	+	+	+	+	+	+	+
	, 12	097-7804458	-	-	+	+	+	+	+	+	+	+	+	+	-	+				
	, 5	(0362) 433340, 067-3604242			+	+	+	+	+	+	+	+	+	+	+	+	+	+	+	+
	, 14	(06563)-22183, 050-9045717	-	-	+	+	+	+	+	+	+	+	+	+	+	+	+	+	+	+
		(06434)-26025, 099-	-	-	+	+	+	+	+	+	+	+	+	+	+	+	+	+	+	+

, 1	2710147	-								
26-	(0692)-555643 (0692)-453699		+	+	+	+	+	+	+	+
, 24	(06452)-50533, 050-6037272	-	+	+	+	+	+	+	+	+
17/1	(0652)-522771, (0652)-544573	" - "	+	+	+	+	+	-	+	
, 72	(0652)-690778	-	+	+	+	+	+	+	+	+
, 32	(04733)-46182	-	+	+	+	+	+	+	+	+
, 1	(06444)-40289, 066-1053966	-	+	+	+	+	+	-	+	
171- \10	(03245)-58381	-	+	+	+	-	-	-	-	
19	096-3400696		+	+	+	+	+	+	+	
, 2	067-3576378, 050-5124887	" "	+	+	+	+	+	+	+	
1/24	(04744)-46614, (04744)-46134	" - "	+	+	+	-	-	-	-	
3/2	(0312)-654266, 099-5575307	-	+	+	+	+	+	+	+	
, 3	(057)-73497 24, (057)-7125181		+	+	+	+	-	+	-	
, 12	(057)- 71713 39, (057)-7021620	-	+	+	+	+	+	+	+	
, 18 (42)	096-5953746	" "	+	+	+	-	-	+	+	
, 25	(057)-7513432, (057)-7643383,		-	-	-	+	+	-	-	

	067-5757009									
, 35	(0552)-420235	-	-	-	-	+	-	-	-	
, 28-	(0552)-434040, 050-4946043		+	+	+	+	+	+	+	
, 23	(0552)-296042		+	+	+	+	+	+	+	
, 7	(0382)-664501, 0630750889	-	+	+	+	-	-	+	+	
, 2	(0382)-704700, (0382)-704707, (03822)-664616	-	+	+	+	+	+	-	-	
, 18	(0382)-783773, (0382)-783755		+	+	+	+	+	+	+	
102 146,	(0472)-563478, (0472)-500354, (0472)-564216, 096-5056363	" - "	+	+	+	+	+	+	+	
, 71	(0472)-314657, (0472)-565621	" - "	+	+	+	-	-	-	+	
. 77- , 1	(0462)-601585	" "	+	+	+	+	+	-	-	
, 265-	(0372)-584301, (0372)-584249	" - "	+	+	+	+	+	-	+	
, 101	(0372)-571204, 066-6604161	-	+	+	+	+	+	+	+	
, 105	(0372)-554869, 050-4345529		+	+	+	-	+	+	+	
, 3	(03840)-40017, 067-3601632		+	+	+	+	+	+	+	
, 3	(0654)-343051, (0654)-343160, 095-7307151	" - "	+	+	+	+	+	-	+	

GB

WARRANTY COUPON

When purchasing the product,
please require its checking before you:

BE SURE

that the goods sold to you, are functional and complete
and that the warranty coupon is filled in correctly.

This warranty coupon confirms the absence of any defects in the product you purchased and provides for free of charge repair of the product failed through the fault of the manufacturer throughout the period of warranty service and free of charge repair.

Failing the presentation of this coupon, in case of its improper filling in, infringement of factory seals (if any), and also in cases indicated in the warranty obligations, the claims are not accepted, and no warranty service and free of charge repair is made!

The warranty coupon is valid only in the original copy with the stamp of trading organization, signature of the seller, date of sale and signature of the buyer.

Complex home appliances should be installed by supplier's authorized service centers, authorized specialists. In the case of a malfunction of the home appliance because of incorrect installation, the buyer must pay the cost of the visit (call) of the specialist, as well as the cost of fault diagnostics if necessary.

CZ

ZÁRUČNÍ LIST

Při koupi výrobku
žádejte o jeho vyzkoušení ve Vaší přítomnosti,

PĚSVDTESE.

že Vám prodaný výrobek je dobře fungující a kompletní
a že záruční list je vyplněn správně.

Tento záruční list potvrzuje, že na Vámi koupeném výrobku nejsou žádné vady a zajišťuje bezplatnou opravu nefungujícího přístroje z viny výrobce, během celé záruční doby.

Bez předložení tohoto listu, při jeho nesprávném vyplnění, porušení plomb výrobce (jsou-li na výrobku) a také v případech, které jsou uvedené v záručním listě, nároky se nepřijímají a záruční oprava se neprovádí!

Záruční list je platný jenom jako originál s razítkem obchodní organizace, podpisem prodávajícího, termínem prodeje a podpisem zákazníka.

Instalace komplexní spotřebiče musí být provedena autorizovaným servisním střediskem, specialistou. V případě poruchy v důsledku nesprávné instalace výrobku, kupující je povinen uhradit náklady na výjezd (volání) odborný, pokud je to nezbytné, a náklady na diagnostiku poruch.

RU

(_____),

!

(_____)

UA

(_____),

!

(_____)

Saturn®

WARRANTY COUPON

ZÁRU NÍ LIST

SATURN HOME APPLIANCES S.R.O. KON VOVA 141, 13083
PRAHA 3 – ŽIŽKOV, ESÁ REPUBLIKA, TEL: + 4202/ 67 108 392

Model/

Serial number/Sériové íslo/

Date of sell/Termín prodeje/

Shop stamp/Razítko obchodu/

Seller's signature/Podpis prodava e/

Buyer's Signature confirming the acquaintance and consent with terms of free of charge maintenance service of the product, and absence of the complaints on appearance and color of the product.

Podpis zákazníka, potvrzující seznámení a souhlas s podmínkami Bezplatného záru ního servisu výrobku, a také neexistence nárok na vn jšek a barvu výrobku.

ВІДМІТКИ ПРО ВСТАНОВЛЕННЯ ВИРОБУ*

Дата встановлення	Назва організації, СЦ	№ наряду	ПІБ та підпис майстра	
			ПІБ та підпис споживача**	

*Побутові прилади, для введення в експлуатацію котрих необхідні установочні, монтажні роботи, повинні вводиться в експлуатацію уповноваженими спеціалістами сервісних центрів постачальника. В разі виникнення несправності виробу з причини некоректної установки вироб може бути знятий з гарантійного обслуговування, а покупець повинен сплатити вартість виїзду (виклику) фахівця, а в разі необхідності і вартість діагностування несправності.

ВІДМІТКИ ПРО ПРОВЕДЕННЯ СЕРВІСНОГО ОБСЛУГОВУВАННЯ

Дата прийому в ремонт	Заявлений споживачем недолік	№ наряду	Назва організації, СЦ	Перелік виконаних робіт	Перелік встановлених запчастин	Дата завершення ремонту	ПІБ та підпис майстра	
							ПІБ та підпис споживача**	

** Підпис споживача свідчить про приймання виробу в робочому стані.

ОТМЕТКИ ОБ УСТАНОВКЕ ИЗДЕЛИЯ*

Дата установки	Название организации, СЦ	№ наряда	ФИО и подпись мастера	
			ФИО и подпись потребителя**	

*Бытовые приборы, для ввода в эксплуатацию которых необходимы установочные, монтажные работы, должны вводиться в эксплуатацию уполномоченными специалистами сервисных центров поставщика. В случае возникновения неисправности по причине некорректной установки, изделие может быть снято с гарантийного обслуживания, а покупатель должен оплатить стоимость выезда (вызова) специалиста, а в случае необходимости и стоимость диагностики неисправности.

ОТМЕТКИ О ПРОВЕДЕНИИ СЕРВИСНОГО ОБСЛУЖИВАНИЯ

Дата приема в ремонт	Заявленный потребителем недостаток	№ наряда	Название организации, СЦ	Перечень выполненных работ	Перечень установленных запчастей	Дата завершения ремонта	ФИО и подпись мастера ФИО и подпись потребителя**

** Подпись потребителя свидетельствует о приеме изделия в рабочем состоянии.

NOTES ABOUT THE INSTALLATION OF THE DEVICE*

Installation date	Name of organization, Service Center	Order No	Master's surname, name, patronymic and signature	
			Client's surname, name, patronymic and signature**	

* Household appliances for commissioning of which installation and mounting works are required should be commissioning by the supplier's authorized service center specialists. In the case of a malfunction of the product because of incorrect installation, the product may become invalid for warranty service, and the buyer must pay the cost of the visit (call) of the specialist, as well as the cost of fault diagnostics if necessary.

NOTES ABOUT CARRYING OUT OF SERVICE MAINTENANCE

Date of receipt for repair	Client's declared problem	Order No	Name of organization, SC	List of performed work	List of installed spare parts	The repair end date	Master's surname, name, patronymic and signature Client's surname, name, patronymic and signature**

** Client's signature certifies about the appliance's receipt at the working condition.

Saturn	Saturn	Saturn
Model/	Model/	Model/
Date of sale/ /	Date of sale/ /	Date of sale/ /
Serial number/ /	Serial number/ /	Serial number/ /
Name of the Trade company and Stamp/ /	Name of the Trade company and Stamp/ /	Name of the Trade company and Stamp/ /
... / Stamp / Stamp / Stamp
Customer's address, phone#, name, surname/ / , , ,	Customer's address, phone#, name, surname/ / , , ,	Customer's address, phone#, name, surname/ / , , ,
.....
Date of Receiving/ /	Date of Receiving/ /	Date of Receiving/ /
Date of Return/ /	Date of Return/ /	Date of Return/ /
Defect / /	Defect / /	Defect / /
Stamp of the Service Center, signature/ / , , ,	Stamp of the Service Center, signature/ / , , ,	Stamp of the Service Center, signature/ / , , ,
... / Stamp / Stamp / Stamp
COUPON 1	COUPON 2	COUPON 3