

# Saturn<sup>®</sup>

ST-MC9184

Multi-Cooker/**Pressure Cooker**

**/Скороварка**

**/Скороварка**



GB

**Multi-Cooker/Pressure Cooker**

Dear Buyer!  
 We congratulate you on having bought the device under trade name "Saturn". We are sure that our devices will become essential and reliable assistance in your housekeeping.

Avoid extreme temperature changes. Rapid temperature change (e.g. when the unit is moved from freezing temperature to a warm room) may cause condensation inside the unit and a malfunction when it is switched on. In this case leave the unit at room temperature for at least 1.5 hours before switching it on.  
 If the unit has been in transit, leave it indoors for at least 1.5 hours before starting operation.

Thank you for your choice in this product. Please read this manual carefully for proper use of this product.

**Table of Contents:**

- 1) Product Features
- 2) Circuit Diagram
- 3) Product Structure
- 4) How to Use This Product
- 5) Menu Setting
- 6) Cleaning Methods
- 7) Safety Rules
- 8) Malfunctions and their solutions

**1) Product Features**

The electric pressure cooker is a brand-new kitchen tool, developed using our latest technology. It is reliable and safe to operate, power saving and delivers quality cooking. It is an ideal cooking tool for a modern family and an excellent substitute for conventional pressure cooker.

This product has the uniqueness as follows:

1. Multi-function: easy operate
  - \* Multi-function: cooking rice, congee, soup, bean, baby food, chicken, steam, cake.
  - \* Just a soft press on the menu button, the utensil will work automatically. A reminder ring will be heard after cooking finished and the cooker will start heat preservation automatically.
2. Fast cooking: time saving comparing to the traditional cooking ways.
3. Retains nutrition: more delicious and healthy;

\* Airproof cooking: conserve nutrition and ensure more delicious food;

Service life – 4 years

**2) Circuit Diagram**

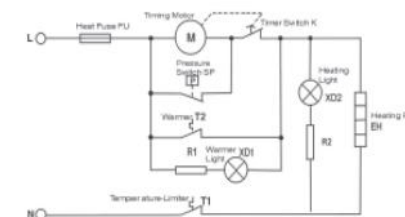

**Computer Elementary Diagram**

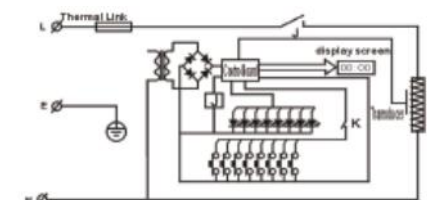

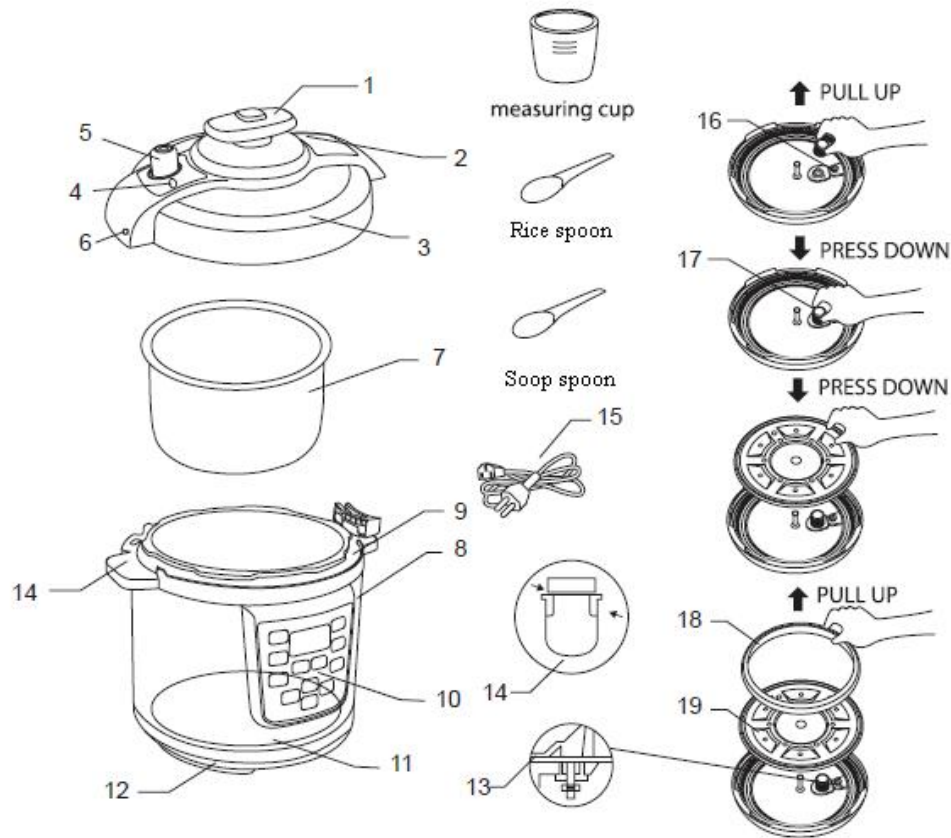

measuring cup



Rice spoon



Soop spoon

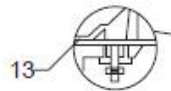
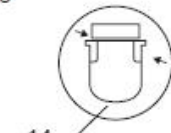

### 3) Product Structure

1. Steam release button
2. Handle
3. Lid
4. Floating Valve
5. Relief Valve
6. Auto Bolt
7. Inner Pot
8. Housing
9. Upper Edge
10. Control Panel
11. Heating Plate
12. Unit Base
13. Floater
14. Water Collector
15. Power Cord
16. Seal Ring for Floating Valve
17. Filter
18. Seal Belt
19. Aluminum Lid

### 4) How To Use This Product

1. Open the lid.  
Hold the handle firmly, turn it clockwise to the clamping position and then lift it. (See Figure 1.). For more convenience the lid can be taken off easily from the bracket.

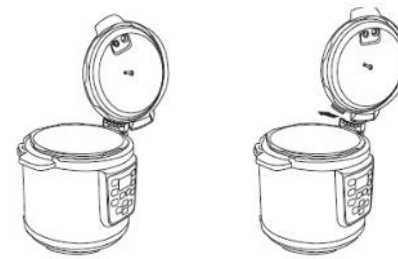

2. Take out the inner pot and place food and water in. The amount of food and water shall not exceed 4/5 of the height of inner pot. For food that will expand in water, the level should not exceed 3/5 of the inner pot. The minimum allowable level would be 1/5 of the inner pot. (See Figure 2.)

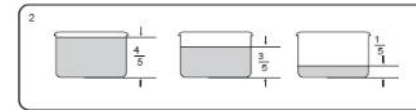

In case of cooking rice, the maximum amount of rice allowed 12 cups. Normally one cup of rice will need one cup of water for cooking rice. But this can be changed according to the taste of different individuals.  
3. Clean the inner pot and heating plate before cooking; be sure there are no sundries left inside the outer pot or on the surface of heating plate; turn the inner pot slightly to fit it well with the heating plate (See Figure 3.)



4. Close the lid  
\*Make sure the seal belt fitted onto the Aluminum lid;  
\*Move the seal belt to make sure it fit snugly in place in the lid;  
\*Close the lid and turn the handle counter-clockwise till a sound of clamping is heard. (See Figure 4.)  
Make sure the lid was closed with a click. Not properly closed lid can result to burns, improper food preparation and fire accident.



5. Switch power on and a sound will be heard, display shows "00:00" in red, indicates that this product is ready for menu setting.

## 5) Menu setting

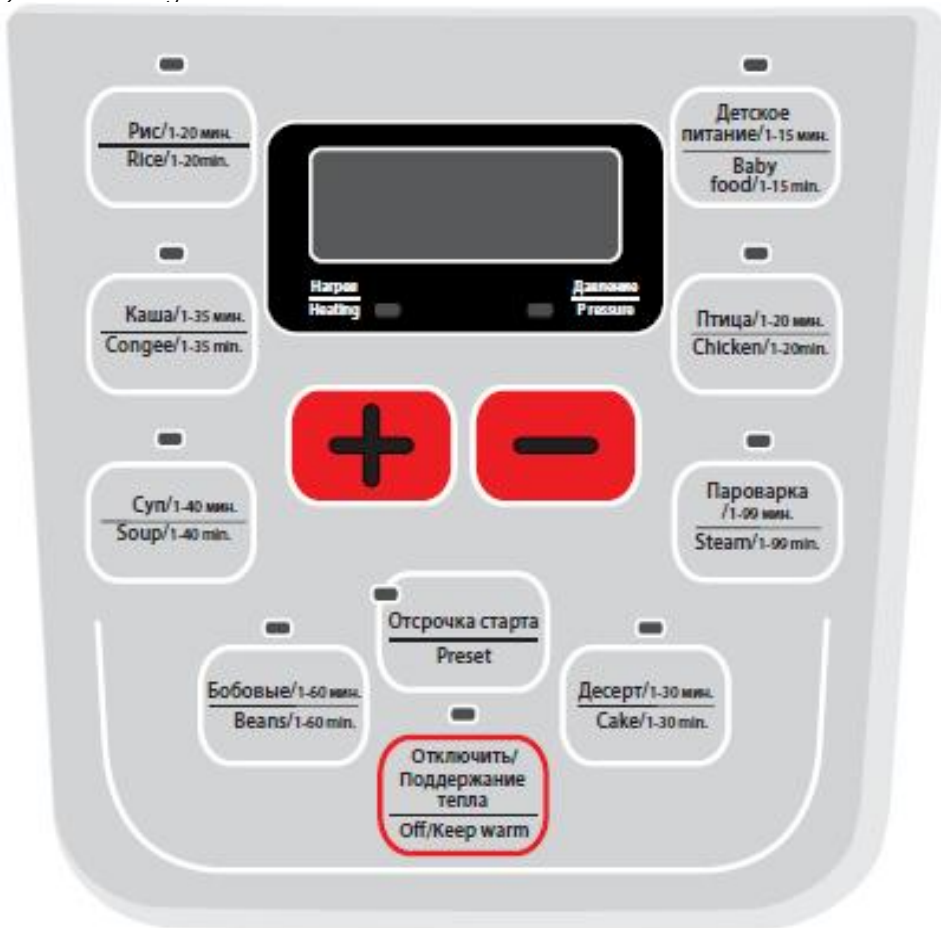

According to the food, choose one of the buttons on the control panel. After selecting cooking program, timer indicator and menu indicator flash synchronously. At this moment, you can press "+" or "-" to adjust the cooking time. Please refer below "COOKING GUIDE".

\* PRESET (« »)

- If preset time is not required, pass this step.
- If preset time is required, press "PRESET" button once to increase the timer by 30 minutes. The maximum preset time is 23 hours and 55 minutes. After 23 hours and 55 minutes, the time will start a new cycle again. You can

long-press the button to increase the preset time quickly. Display shows the default cooking time. Chosen program will be indicated by light indicator. Cooking process will start after preset time is over.

By pressing button at the control panel choose the cooking program. Cooking mode and default corresponding time will be on display. To change cooking time press "+" or "-". Timer indicator will flash 5 times and the cooking time will start.

Program	Default Time	Time change range
Rice	12 minutes	1-20
Congee	15 minutes	1-35 minutes
Chicken	12 minutes	1-20 minutes
Soup	25 minutes	1-40 minutes
Beans	40	1-60
Baby food	5	1-15
Steam	55	1-99
Cake	30	1-30

\* Off/ Keep Warm

a) When the cooking process is over, the product keep warm function will turn on automatically.

b) At any stage, you can just press "OFF/ KEEP WARM" button to stop the current operation menu and return back to original stage.

\* Take Out The Food

a) When the cooking process are over, the product will signal 3 times and the display will be on continual warm function.

b) By pressing the button at the center of the handle (See Figure 5.) release the steam.

5



c) Unplug the power supply.

d) Hold the handle firmly, turn it clockwise to the clamping position and then lift it. (See Figure 1).

6) Cleaning Methods

- Remove the plug before cleaning
- Clean the lid, including seal belt, pressure relief valve, filter, vent, floater, floating valve and wipe it with towel.

3. Clean the body with soft towel. Never soak it in water for cleaning or spray water over it.

4. Take off the water collector and clean it with a wet towel.

5. Clean the inner pot with a sponge or non-metal soft brush, and then dry it with towel.

6. Clean the pressure relief valve and the holes with soft brush to ensure smooth flow of steam during the cooking process.

7) Safety Rules

1. Never use the utensil along with inflammable products or in a humid location.

2. The amount of water or food added to the inner pot should be determined in line with step 2 in the section "HOW TO USE THIS PRODUCT".

3. Never damage the seal belt or replace it with other rubber belt or tension belt.

4. Never twist the inner steel ring with hand or other tools with force. If the steel ring slips off place, do stop using and replace a new lid.

5. Never attempt to open the lid with force until the floating valve falls down.

6. Never put any weight on the pressure relief valve or replace it with other substitutes.

7. The bottom of inner pot and heating plate surface should be kept clean. Never heat the inner pot on other thermal sources or have it replaced with other cookers.

8. The inner pot is covered with anti-sticking coating. To avoid scratch, wooden or plastic ladles are recommended.

9. The maximum period for heat preservation is 24 hours. However, the duration less than 6 hours is recommended to ensure delicious taste.

10. It is abnormal if there is large amount of steam escaping from the edge of lid during cooking. Remove the plug immediately and send the utensil to authorized service station for maintenance.

11. In cooking, if an alarm sound is heard and the following malfunction code is displayed, stop using immediately and send the utensil to authorized service station for maintenance.

12. In transit, it is recommended to hold the ears instead of the handles for safety.

13. Never disassemble the utensil by yourself or make replacement with accessories other than ours.

14. To avoid burns of heated steam and water do not open the multi-cooker's lid during the operation!

### 8) Malfunctions And Their Solutions

Malfunction Code	Problems / Causes
E1	Open circuit of the sensor
E2	Short circuit of the sensor
E3	Overheating
E4	Signal switch malfunction

	Situation	Causes	Solution
1	Difficulty in closing the lid	Seal belt is not properly fitted	Fit in the seal belt properly
		Floating valve stuck on the bar	Push the bar lightly
2	Difficulty in opening the lid	Floating valve has not sunk	Press the valve slightly with chopsticks
		Steam leaking out around the lid	Seal belt is not in place
3		Dirty seal belt	Clean the seal belt
		Damaged seal belt	Replace the seal belt
		Lid is not closed tightly	Close the lid according to the instructions
4	Steam leakage from the floating valve	Dirty seal ring for floating valve	Clean the seal ring for floating valve
		Damaged seal ring for floating valve	Replace the seal ring for floating valve

5	Floating valve is not rising up	The amount of food and water is lower than the minimum level	Determine the amount of food according to the instructions
		Steam leakage around the lid or from pressure relief valve	Send the product to the Service Center for checking purposes

### Specification

Power: 1000 W  
 Rated Voltage: 220-240 V  
 Rated Frequency: 50 Hz  
 Rated Current: 4.4 A  
 Capacity: 6 l

### Set

Multi-Cooker/ Pressure Cooker 1  
 Instruction Manual with Warranty Book 1  
 Measuring cup Soup spoon 1  
 Rice spoon Steamer attachment Package 1

Environment friendly disposal  
 You can help protect the environment!



Please remember to respect the local regulations: hand in the non-working electrical equipments to an appropriate waste disposal centre.

The manufacturer reserves the right to change the specification and design of goods.

RU

### /Скороварка

"Saturn".

\*

2.

3.

\*

-4

2)

1,5

1,5

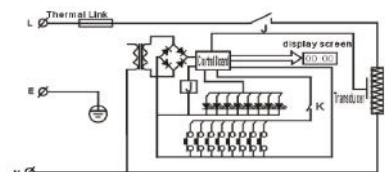
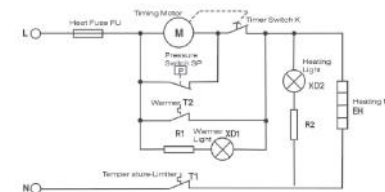

- 1)
- 2)
- 3)
- 4)
- 5)
- 6)
- 7)
- 8)

1)

1.

\*



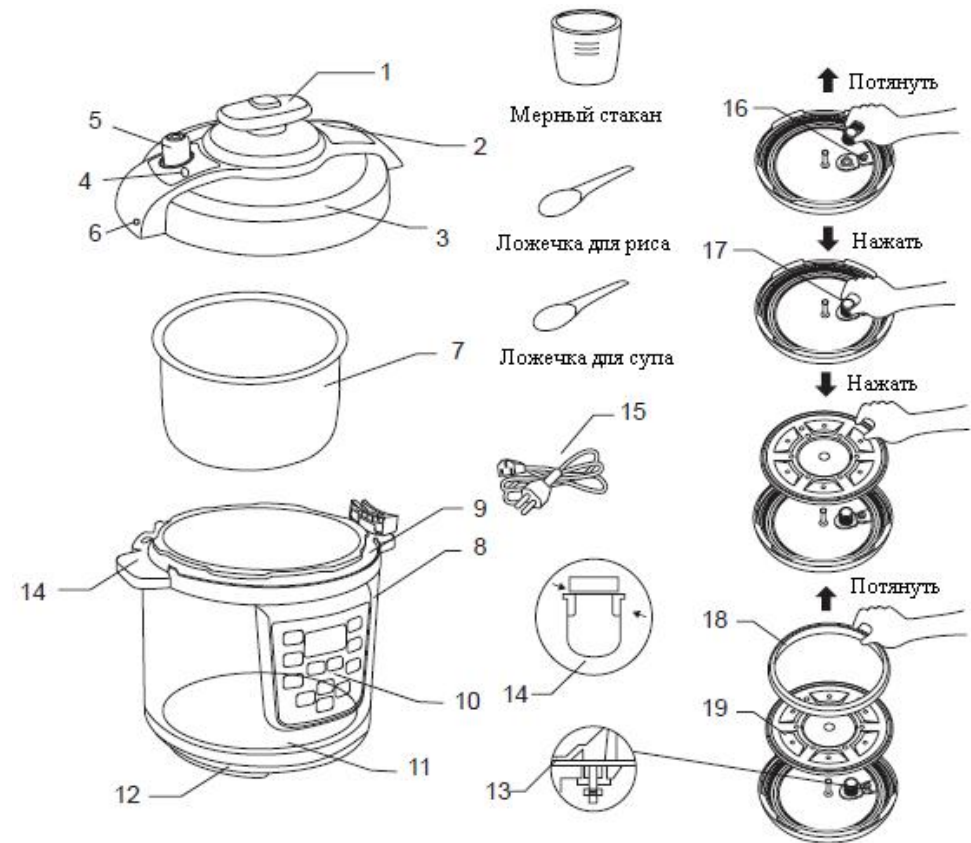

- 3)
- 1.
- 2.
- 3.
- 4.
- 5.
- 6.
- 7.
- 8.
- 9.
- 10.
- 11.
- 12.
- 13.
- 14.
- 15.
- 16.
- 17.
- 18.
- 19.

4)

1).



10

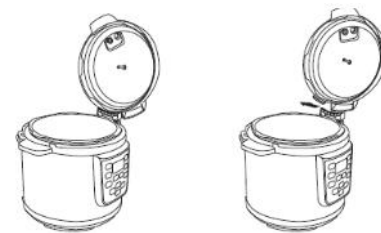

2.

4/5

1/5

( . . . 2).

3/5

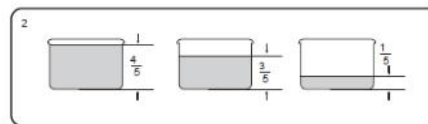

\*

- 12

1:1

3.

( . . . 3).



4.

\*

\*

( . . . 4).



6.

«00:00».

11

5)

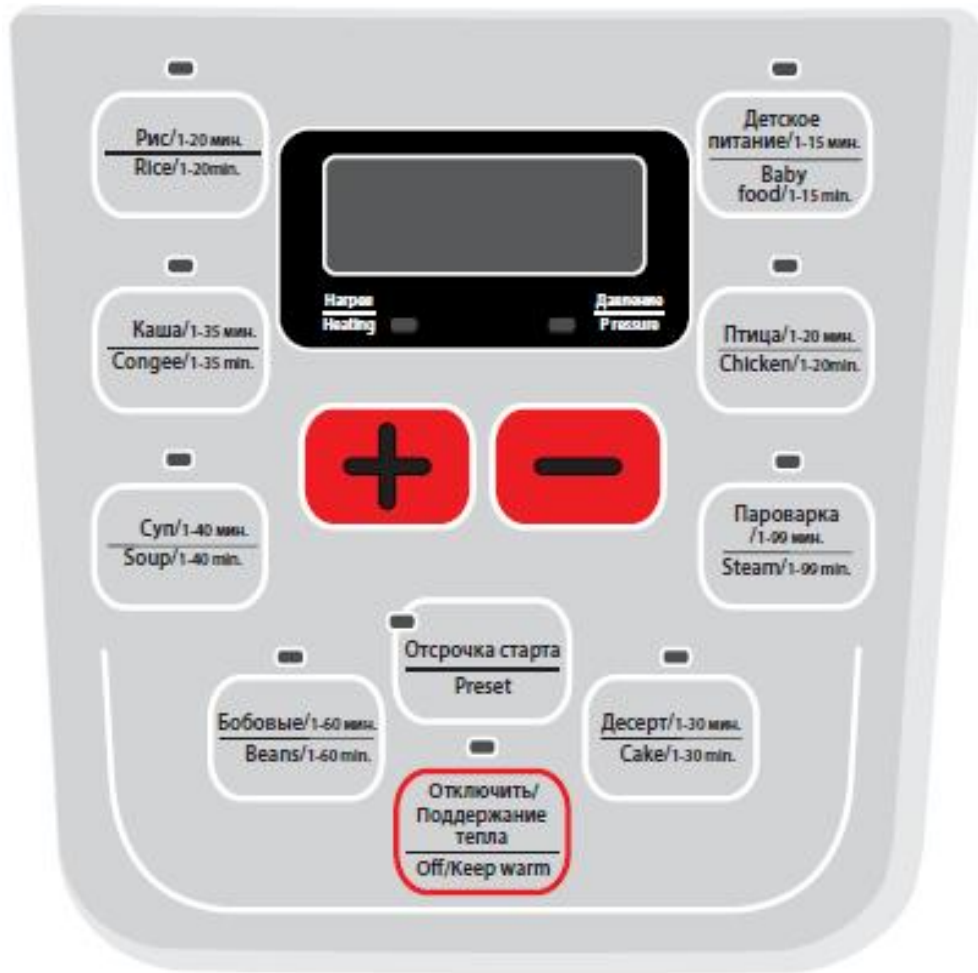

“PRESET” ( « » )

“\_” “+”

23 55 : 23 55

5



«+» «-».

5

	12	1-20
	15	1-35
	12	1-20
	25	1-40
	40	1-60
	5	1-15
	55	1-99
	30	1-30

\* OFF / KEEP WARM

( / )

)

“OFF/KEEP WARM”

\*

)

)

( . . . 5.),

)

( . . . 1.).

6)

1.

2.

3.

4.

5.

6.

7)

1.

2.

3.

4.

5.

- 6.
- 7.
- 8.
- 9. - 24
- 10. 6
- 11.
- 12.
- 13.
- 14.
- 8)

		-	
2			
3		-	-
4		-	-
5		-	-

	/
E1	
E2	
E3	
E4	

	-		
1	-	-	-

/Скороварка

- 1
- 1
- 1
- 1
- 1
- 1
- 1



U

/Скороварка

"Saturn".

- 1)
- 2)
- 3)
- 4)
- 5)
- 6)
- 7)
- 8)

1)

1.

\*

\*

2.

3.

\*

- 4

2)

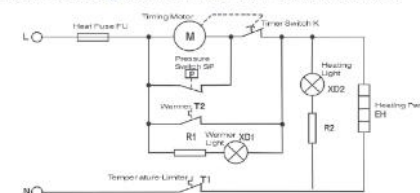

1,5

1,5

1000  
220-240  
50  
4.4  
6



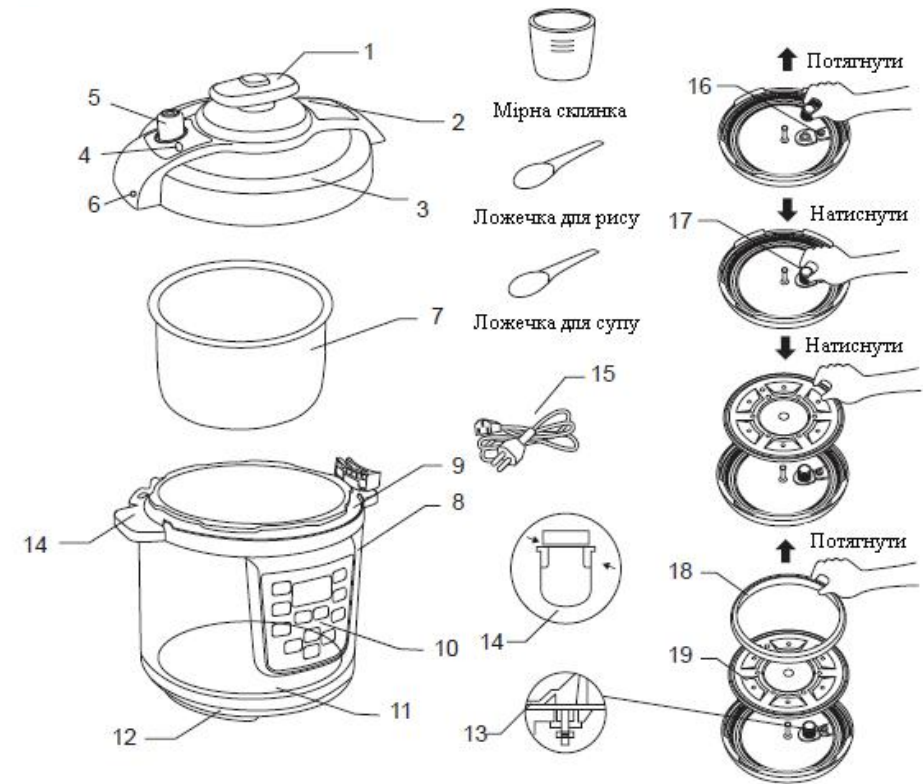
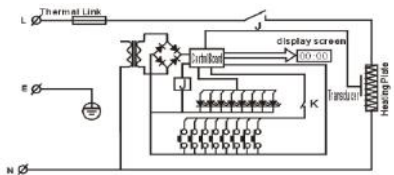

- 3)
- 1.
- 2.
- 3.
- 4.
- 5.
- 6.
- 7.
- 8.
- 9.
- 10.
- 11.
- 12.
- 13.
- 14.

- 15.
- 16.
- 17.
- 18.
- 19.

- 4)
- 1.

( . . . 1).

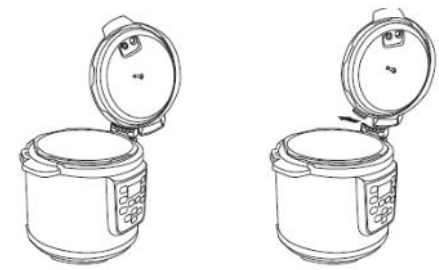

2.

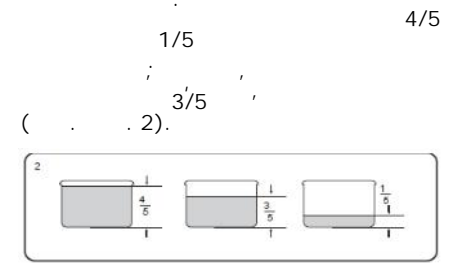

\*

- 12 : 1:1, 1

3.

( . . . 3).

- 4.
- \*
- \*
- \*

( . . . 4).



5.

«00:00».

5)

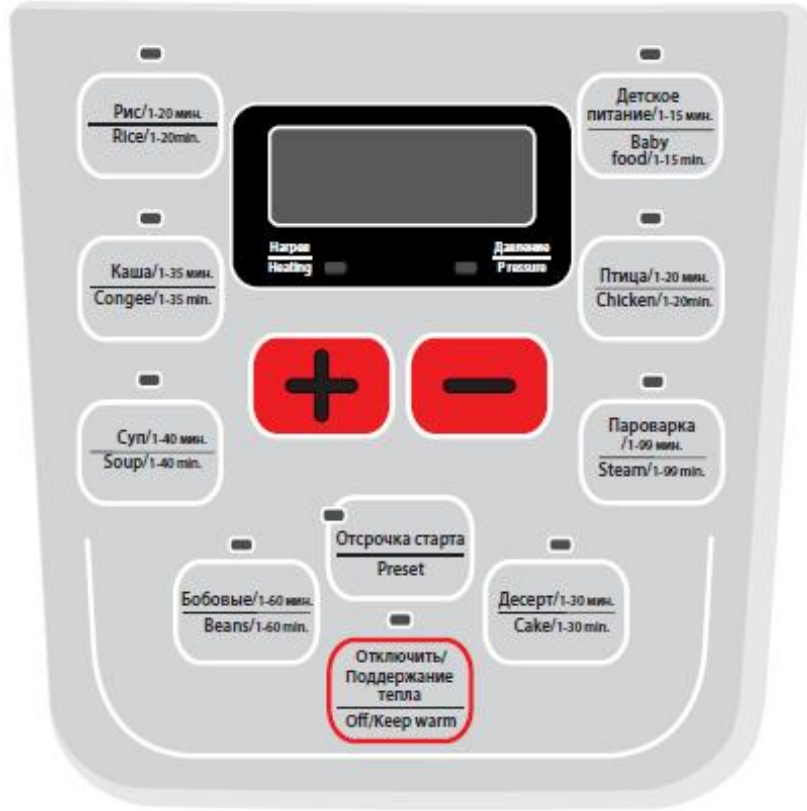

	15	1-35
	12	1-20
	25	1-40
	40	1-60
	5	1-15
	55	1-99
	30	1-30

OFF/KEEP WARM

( / )

)

WARM»

\*

)

)

5



)

)

( 1.)

6)

1.

2.

3.

4.

5.

6.

7)

1.

2.

3.

4.

5.

6.

7.

8.

9.

10.

11.

12.

13. -  
 14. -  
 8) -

	/
E1	-
E2	
E3	
E4	-

5	-	-	-
	-	-	-

1	-	-	-
2	-		-
3		-	-
		-	-
		-	-
4	-	-	-
		-	-
		-	-

1000  
 220-240  
 50  
 4.4  
 6  
 /Скороварка 1  
 1  
 1  
 1  
 1  
 1  
 1



# Saturn®

**INTERNATIONAL  
 MANUFACTURER'S WARRANTY**

**MEZINÁRODNÍ ZÁRUKA**

## INTERNATIONAL MANUFACTURER'S WARRANTY

The Warranty is provided for the period of 2 years or more if the Law on User Right of the country where the appliance was bought provides for a greater minimum warranty period.

All terms of warranty comply with to the Law on Protection of the Consumer Rights and are governed by the legislation of the country where the product was bought. The warranty and free of charge repair are provided in any country where the product is delivered to by Saturn Home Appliances or authorized representative thereof, and where no restriction of import or other legal provisions interfere with rendering of warranty services and free of charge repair.

Cases uncovered by the warranty and free of charge repair:

1. Guarantee coupon is filled in improperly.
2. The product has become inoperable because of the Buyer's nonobservance of the service regulations indicated in the instruction.
3. The product was used for professional, commercial or industrial purposes (except for the models, specially intended for this purpose that is indicated in the instruction).
4. The product has external mechanical damage or damage caused by penetration of the liquid inside, dust, insects and other foreign objects.
5. The product has damages caused by non-observance of the rules of power supply from batteries, mains or accumulators.
6. The product was exposed to opening, repair or modification of design by the persons, unauthorized to repair; independent cleaning of internal mechanisms etc. was made.
7. The product has natural wear of parts with limited service life, expendables etc.
8. The product has deposits of scale inside or outside of fire-bar elements, irrespective of used water quality.
9. The product has damages caused by effect of high (low) temperatures or fire on non-heat resistant parts of the product.
10. The product has damages of accessories and nozzles which are included into the complete set of product shipment (filters, grids, bags, flasks, cups, covers, knives, sealing rings, graters, disks, plates, tubes, hoses, brushes, and also power cords, headphone cords etc.).
11. A defect was a result of inappropriate installing of the appliance by non-specialists of the supplier's authorized service center.

On the warranty service and repair, please contact the authorized service centers of "Saturn Home Appliances".

## MEZI NÁRODNÍ ZÁRUKA

Záruka se poskytuje na dobu 2 roky. V případě že Zákon na ochranu spotřebitelů dané země stanoví delší dobu, prodlužuje se záruka na tuto dobu.

Veškeré záruční podmínky odpovídají Zákonu o ochraně práv uživatelů a jsou řízeny zákonodárstvím státu, kde byl výrobek koupen. Záruka a bezplatná oprava se poskytují v každém státě, kam jsou výrobky dodány společností „Saturn Home Appliances“ nebo jejím zplnomocněným zástupcem a kde nejsou žádná omezení na dovoz nebo jiné právní předpisy omezující poskytnutí záručního servisu a bezplatné opravy.

Případy, na které se záruka a bezplatná oprava nevztahují

1. Záruční list je vyplněn nesprávně.
2. Výrobek byl poškozen kvůli tomu, že zákazník nesplnil pravidla použití, která jsou uvedena v návodu.
3. Výrobek byl používán k profesionálním, komerčním nebo průmyslovým účelům (kromě modelů speciálně určených pro tyto účely, což je uvedeno v návodu).
4. Výrobek má vnější mechanická poškození nebo poškození, vyvolaná tím, že se dovnitř dostala tekutina, prach, hmyz a jiné cizí předměty.
5. Výrobek má poškození, která jsou vyvolaná nesplněním pravidel napájení od baterií, sítě nebo akumulátorů.
6. Výrobek rozebírali, opravovali nebo měnili jeho konstrukci lidé, kteří nebyli zplnomocněni k opravě, bylo provedeno samostatné čištění vnitřních mechanismů a pod.
7. Výrobek má přirozené opotřebování dílů s omezenou dobou použití, spotřebních materiálů atd.
8. Výrobek má vrstvu usazeniny uvnitř nebo zvenku termoelektrických ohřevů, bez ohledu na kvalitu používané vody.
9. Výrobek má poškození, která jsou vyvolána působením vysokých (nízkých) teplot nebo ohněm na termonestabilní části výrobku.
10. Výrobek má poškozené příslušenství a nástavce, které jsou dodány spolu s výrobkem (filtry, sícky, sáčky, bafly, mísy, víka, nože, šlehače, struhadla, kotouče, talíře, trubky, hadice, kartáče a také síťové šňůry, sluchátkové šňůry atd.).
11. Vada je důsledkem nesprávné instalace výrobku neoprávněnou osobou.

V otázkách záručního servisu a oprav se obraťte na autorizovanou servisní středisko společnosti „Saturn Home Appliances“.

2

«Saturn Home Appliances»

- 1.
- 2.
- 3.
- 4.
- 5.
- 6.
- 7.
- 8.
- 9.
- 10.
- 11.

« Saturn Home Appliances»

: <http://saturn.ua/ru/servis>,  
: 0-800 505-27-09

					LCD	
	« C »	8 (988) 993-37-78	+		+	+
18		8 (8553) 32-22-11 8 (960) 047-22-11	+	+	+	+
98	« »	8 (86133) 6-09-84, 8(918) 215-57-75	+	+	+	+
109		8 (86152) 2-81-99	+	+	+	+
1, 12	« -29»	8 (8182) 44-15-55	+			
47	« »	8 (8512) 25-19-39, 8 (8512) 25-12-00	+	+	+	
54	" - "	8 (8512) 50-19-97	+		+	
2	« »	8 (8512) 54-67-67, 8 (8512) 54-91-91		+		+
15	« »	8 (85141) 3-61-25	+	+	+	+
32		8 (927) 552-47-21, 8 (937) 122-13-99				+
113	« »	8 (3852) 63-94-02	+		+	+
25		8 (905) 425-60-4-73	+	+	+	
37		8 (8635) 47-47-72	+	+	+	+
63	« »	8 (86155) 3-11-00, 8 (918) 980-64-75	+	+	+	+
18	" - "	8 (3535) 23-23-98, 8-922-802-21-58	+	+	+	+

	, 84		8 (86559) 2-08-02, 8 (86559) 5-29-71	+	+	+	+	+
36		« - »	8 (3955) 67-00-44, 8(3955) 56-61-93	+	+	+	+	+
	, 3	« »	8(4832) 63-06-00, 8 (4832) 33-15-61		+			
173		« »	8 (8442) 97-50-10, 8 (960) 883-59-00		+			
	, 4		8 (8442) 98-16-47, 8 (8442) 53-06-04	+	+	+	+	+
11		« - »	8 (8442) 37-16-74, 8 (8442) 37-69-03		+			
		« - »	8 (961) 688-53-48		+			
	, 9		8 (927) 521-52-00		+		+	+
32			8 (937) 722-68-12				+	+
	, 158		8 (937) 730-66-03		+		+	+
			8 (904) 404-14-55				+	+
- . C 12/15		«Master»	8 (928) 126-63-66	+		+		
	, 110	«X »	8(8639) 27-80-47	+	+	+	+	+
77- 65		« »	8 (937) 717-93-36	+		+		
	, 65	« »	8 (8172) 70-03-45, 8 (8172) 54-21-54	+		+	+	+
	, 1	« »	8 (8172) 52-72-51	+		+		

46		« »	8 (473) 260-09-08, 8 (473) 240-57-73	+		+	+	
.13		« »	8 (38822) 6-23-32	+		+	+	+
	, 48	« »	8 (962) 655-20-00	+	+	+	+	+
	, 68	« »	8 (8313) 21-14-14	+		+		
54		« »	8(8313) 20-56-00	+	+	+	+	
	, 63	« »	8 (84235) 2-86-59, 8 (84235) 9-14-64	+		+	+	+
	, 84	« - »	8 (86132) 2-11-71, 8 (86132), 3-66-02	+	+	+	+	+
	, 55	« »	8(86132)5-05-00	+	+		+	+
64		« »	8 (343) 240-26-60	+		+		
7, 201.		«GOLD»	8-919-372-28-4		+			+
3, 81,		« - »	8(3955) 67-00-44, 8 (3955) 56-61-118	+		+	+	+
	, 22		8(86359) 4-32-23, 8 (86359) 4-06-42			+		
47		« »	8 (47467) 4-12-08, 8 (47467) 4-33-17	+		+		
, 45/6		« »	8 (4932) 335185, 8 (4932) 335236	+	+	+	+	+
	, 4	« - »	8 (3412) 30 79-79, 8 (3412)30-83-07	+		+	+	+
	, 76	« - »	8 (3412) 78-76-85, 8 (3412) 78-06-64	+		+	+	+
. 7/1, 301, 307		« - »	8 (3412) 44-60-40, 8 (3412) 44-60-67			+		
- (« »	26»	« »	8 (86545) 2-74-74		+			



«	»)							
	24	«	»	8 (8362) 24-11-24, 8(8362) 25-55-40	+	+	+	+
	24	«	»	8 (3952) 42-55-76 8 (3952) 78-15-83	+		+	+
	56	«	»	8 (3952) 28-74-50, 8 (3952) 76-71-75		+		+
	183	«	»	8 (34551) 7-46-31				+
	33			8 (3439) 39-95-20, 8 (34399) 34-74-40	+	+	+	+
	6	«	»	8 (84457) 9-17-43, 8 (84457) 9-45-89	+	+	+	+
157				8 (8734) 44-42-44	+	+		+
53/2				8 (3842) 35-39-67	+			+
	17	«	»	8 (87239) 2-33-55, 8 (87239) 3-01-77	+	+	+	+
	42	«	»	8 (8332) 56-25-95, 8 (8332) 54-70-77	+		+	+
	9			8 (988) 548-24-36	+		+	
	9			8-928-172-52-26		+		
	2			8 (86142) 4-43-59	+	+	+	+
	1	«	»	8-918-936-36-53		+		+
3				8(861) 267-50-88	+	+	+	+

103,	55	«	»	8 (861) 222-64-13, 8 (861) 222-85-55, 8 (905) 408-08-38	+	+	+	+	+
106		«	»	8 (86156) 3-40-40, 8-918-990-35-04	+		+	+	
	42/2			8 (918) 041-31-04, 8(86131) 71-2-72			+		+
	116			8 (86164) 7-01-22		+			
	57	«	»	8 (86145) 3-78-74		+			+
	25	«	»	8 (86164) 65-4-95, 8-918-355-81-70	+	+		+	+
	1			8 (86153) 4-16-70		+			
	168	«	»	8 (86151) 4-33-54, 8 (918) 464-00-86	+	+		+	+
	6	«	»	8 (3912) 92-92-22, 8 (3912) 41-78-88	+	+	+	+	+
	1	«	»	8 (3912) 93-54-33, 8 (3912) 94-52-82	+	+	+	+	+
37	36	«	+»	8 (4712) 50-85-90, 8 (4712) 35-04-91	+	+	+	+	
	2	«	»	8 (86169) 7-39-99, 8 (86169) 7-24-96	+	+	+	+	+
66		«	»	8 (4742) 33-45-65, 8 (4742) 33-45-95	+	+	+	+	+

25	« - »	8 (8772) 55-62-38	+	+	+	+	+
, 20	« »	8 ( 8722) 93-30-73	+	+	+	+	+
11	« »	8 (86385) 2-33-26, 8 (960) 458-07-11	+	+		+	+
, 9	«X »	8-909-401-35-21	+	+	+	+	+
1534	« - »	8 (499) 717-82-07, 8 (499) 717-82-12	+		+	+	+
, 3	« »	8 (495) 721-30-70, 8 (499) 168-05-19, 8 (499) 168-47-15	+		+	+	+
(30/05), 20	« »	8 (8552) 35-90-02, 8 (8522) 35-90-42	+	+	+	+	+
24	« - »	8 (8662) 42-04-30, 8 (8662) 42-12-21	+		+	+	
, 55	« »	8 (86554) 5-59-77, 8 (86554) 3-67-57	+	+	+	+	+
, 10	« - »	8 (34783) 3-43-44	+	+	+	+	+
( « , 9 »)	« »	8 (8555) 48-08-80, 8-917-906-60-06	+		+	+	+
, 18	« - »	8 (831) 46-18-848		+			+
6	« »	8 (831) 46-18-848		+			+
, 18	« »	8 (3843) 20-31-33	+		+	+	+

.21/27	« »	8 (48762) 6-46-46	+	+	+	+	+
, 14	« - »	8 (8617) 6311-15, 8 (8617) 63-03-95	+	+	+	+	+
, 17	« - »	8 (383)274-99-33, 8 (383) 274-99-45	+		+		
63, 3	« »	8 (383) 210-59-49, 8 (383) 210-52-92	+		+	+	
24		8 (86369) 3-74-75, 8 (928) 609-35-85	+	+	+		
, 4		8 (3532) 36-87-94	+			+	+
, 194	« »	8 (3812) 36-74-01					+
130	« - »	8 (3812) 36-42-02	+	+	+	+	
, 2	« - + »	8 (3537) 33-84-43, 8 (3537) 35-13-18	+	+	+	+	+
, 11	« - »	8 (3537) 35-79-93	+	+	+	+	+
, 2	« »	8 (8412) 26-09-60, 8 (8412) 26-12-29	+		+	+	+
, 3,	« - »	8 (342) 221-40-99	+	+	+	+	+
, 11	« - »	8 (342) 240-93-35, 8 (342) 240-93-24			+		
11	« - »	8 (8142) 78-06-93, 8 (8142) 70-65-48	+		+		
39-5		8 (3846) 69-33-00	+	+	+	+	+
, 11	« »	8 (8112)-53-86-30, 8 (8112) 53-86-50	+		+		
12		8-928-225-95-85			+		+
5-3	« »	8 (8793) 98-70-11	+	+	+	+	+

		8 (47396) 48-911	+	+	+	+	+
37	« »	8 (863) 250-47-77	+		+		
7	« »	8 (863) 227-60-90, 8 (863) 299-00-50	+	+	+	+	+
1/52, 55	« »	8 (863) 21-92-112, 8-800-100-51-52	+	+	+	+	+
17		8 (906) 453-35-81	+		+		
12	« »	8 (4855) 22-04-77, 8 (4855) 25-38-60	+	+	+	+	+
14	« »	8 (86370) 2-19-50	+	+	+	+	+
12	« »	8 (4855) 22-04-77, 8 (4855) 25-38-60	+	+	+	+	+
21	« »	8 (4855) 24-31-21	+	+	+	+	+
14, 1	« »	8 (4912) 76-88-01, 8 (4912) 40-30-30	+	+	+	+	+
42	« »	8 (4912) 41-33-02	+	+	+	+	+
100/ 56	« »	8 (846) 990-37-51, 8 (846) 240-98-17	+		+	+	+
e 197	« XXI »	8 (812) 600-11-97	+	+	+	+	
e 41,	« »	8 (812) 325-36-56, 8 (812) 325-36-57	+		+	+	

e 11, 36	95» « -	8 (812) 822-18-00, 8 (812) 320-06-61	+				
1	« »	8 (8342) 23-05-91, 8 (8342) 47-48-59	+	+	+		
95	« »	8 (8452) 52-81-21, 8 (8452) 52-83-84	+	+	+	+	+
167/1		8 (951)-522-38-11	+	+	+	+	+
253	« »	8 (496) 547-04-95, 8 (496) 549-32-79	+	+		+	+
7	S" " -	8-963-624-49-46				+	+
44	« »	8 (4812) 45-05-13, 8-920-333-09-44	+	+	+	+	+
90	« »	8 (8622) 55-51-19, 8 (8622) 55-01-08	+			+	+
63	« »	8 (8652) 24-30-14, 8 (8652) 23-31-81	+	+	+	+	+
15, 21	« »	8 (8652) 95-53-68, 8 (8652) 95-61-90				+	
1	« »	8 (4725) 24-62-27, 8 (4725) 24-73-49	+	+	+		
158	« »	8 (3473) 20-12-13, 8 (3473) 20-27-70	+			+	+
25	« »	8 (8212) 22-95-29, 8 (8212) 29-12-20	+	+	+	+	+
137	2000» « -	8 (4752) 56-19-42, 8 (4752) 56-19-44	+	+	+	+	+

24/2	-	8 (86130) 4-86-59, 8-(918) 147-02-03	+	+		+	+
, 2/2	« - »	8 (86196) 7-20-53	+	+	+	+	+
, 48	« + »	8 (8482) 22-72-41, 8 (8482) 22-71-85, 8 (8482) 61-65-64	+	+	+	+	+
, 58	« -2 »	8 (3822) 56-23-35, 8 (3822) 48-08-80	+		+		
137	« - »	8 (4872) 31-12-57	+	+	+	+	+
, 55	« »	8 (3452) 47-35-69	+		+	+	+
, 28	« »	8 (3012) 21-89-63	+		+	+	+
16/7	« - »	8 (8422) 73-44-22, 8 (8422) 73-29-19	+	+		+	+
378	« - »	8 (87875) 7-44-82	+	+	+	+	+
, 6/1	« - »	8 (347) 236-57-07	+		+		
148	« » -	8 (3472) 77-12-62	+		+		
, 153, , 42, , 7	« »	8 (347) 279-90-70, 8 (347) 241-62-02					+
, 15	« - »	8 (86391) 2-18-06	+		+		
, 36	« »	8 (8352) 62-30-97, 8 (4942) 63-20-98	+		+		
, 8	-	8 (351) 239-39-34, 8 (351) 239-39-35	+	+	+	+	+
18	« - »	8 (8202) 54-31-88	+		+	+	+

340 « »	« - »	8 (8782) 27-30-60, 8 (8782) 27-70-77	+	+	+	+	+
, 48, , 11	« . . »	8 (8782) 25-04-66, 8 (8782) 25-19-15	+	+	+	+	+
, 33	« - »	8 (3022) 36-39-36, 8 (3022) 36-39-32	+	+	+	+	+
, 1		8 (904)-345-83-18	+	+	+	+	+
, 3- , 21	« »	8 (84722) 9-52-07, 8 (937) 469-52-07	+	+	+	+	+
57	« - »	8 (8453) 55-80-89, 8 (964) 848-45-06	+		+	+	+
, 12	« - »	8 (4852) 25-94-83	+		+		

«Saturn Home Appliances»

- 1.
- 2.
- 3.
- 4.
- 5.
- 6.
- 7.
- 8.
- 9.
- 10.
- 11.

« Saturn Home Appliances» .

: <http://saturn.ua>,

0-800 502-502

, 36	(06442)-91137, .0990521001	Hi-Fi ( )	-	+	+	+	+	+	-	+	
, 42	(06274)-49128, 0627449129	-	-	+	+	+	+	+	-	+	
50-82	(04563)-68413	-	-	+	+	+	+	+	-	+	
, 28	(0456)-333295, (0456)-309400, .094-9299400	-	-	-	+	+	+	+	-	-	
, 57	(04143)-40636	" "	-	+	+	+	-	+	+	+	
, 43	(03141)-43432	" "	-	+	+	+	+	-	-	-	
, 51	(0432)-699573		-	+	+	+	+	+	+	+	
, 3	(0432)-642457, (0432)-642622		-	+	+	-	-	-	-	-	
, 1	(0432)-509191, (0432)-579191, .066-3509191 .096-0509191	-	-	+	+	+	+	+	-	+	
, 16	(0432)-464393, (0432)-468213, (0432)-519254	-	-	+	+	+	+	+	+	+	
, 43	.067-7899525	-	-	+	+	+	-	-	-	-	
, 62-	(05653)-52771		-	+	+	+	+	+	+	+	
, 59	(0562)-350409, (0562)-346705		-	+	+	+	+	+	-	+	
, 6	(056)-7356328, (056)-7356325	-	-	+	+	+	+	+	-	+	
, 46-	(056)-7854002, .067-5071964	-	-	-	+	+	+	+	+	-	
, ,	(056)-7900460	-	-	+	+	+	+	+	-	+	

41-		-									
129-	.066-2493639	-	+	+	+	-	-	-	-	+	
1	.066-5082652, .096-7232447	-	+	+	+	+	+	+	+	+	
188	(062)-3450607	-	+	+	+	+	+	-	-	+	
24	(0412)-470742	C - ( )	-	-	+	+	+	-	-	-	
8	(0412)-471568, .067-4115812	( " - ")	-	+	+	+	-	-	-	+	
175	(061)-7875051, (0612)-639790		+	+	+	+	+	+	+	+	
83	(0612)-120303	-	+	+	+	+	-	-	-	+	
50	(061)-2209764, (061)-2209765	-	+	+	+	+	+	-	-	+	
223	(0342)-756040, (0342)-712813		+	+	+	+	+	-	-	-	
19-	(0342)-559525, (0342)-750777		+	+	+	+	-	-	-	-	
2	.067-3248218	" - "	+	+	+	+	+	+	+	+	
76	(04597)-57393	" - "	+	+	+	-	-	-	-	-	
161	.067-3248401, .067-3248365, (04736)-62949	« - - »	+	+	+	+	+	+	+	+	
16	(044)-4269198, (044)-3629198	" "	+	+	-	-	-	-	-	+	
55	(044)-3641463, (044)-4086660, (044)-4972936, (044)-4973455, (044)-4973619, (044)-4086658, (044)-4086659	- - - - - - -	-	+	+	+	+	+	+	-	
-	(044)-5911190	" - "	+	+	+	+	+	+	+	+	

1-											
15	(06561)-62102, .096-3852181		+	+	+	-	-	-	-	+	
2	(0522)-357923, (0522)-278002, (0522)-273300		+	+	+	+	+	-	-	+	
1-	(0522)-272840, (0522)-277667	- ( - )	+	+	+	+	+	+	+	+	
13	.097-7766770 .097-2642167		+	+	+	+	+	+	+	+	
10	(06272)-26223, (06272)-22186, .050-2796816	( )	+	+	+	-	-	-	-	-	
2-	(04142)-50504	" "	-	+	+	+	+	+	+	+	
7	.050-5260668	-	+	+	+	+	+	+	+	+	
3	(06264)-59389		+	+	+	+	-	+	-	-	
20		-	+	+	+	+	+	-	-	+	
8	.050-9732014		+	+	+	+	+	+	+	+	
5-	(0626)-412134, .067-2557990		+	+	+	+	+	+	+	+	
44,	(05366)-39192		+	+	+	+	+	+	+	+	
2	(056)-4013356, (056)-4040080, (056)-4746103	" - "	+	+	+	-	+	+	+	-	
73	(056)-4400764	" - "	+	+	+	+	+	+	-	+	
64/7	(056)-4400779		+	+	+	+	+	+	-	+	
9	(056)-4092302, (056)-4092303	( - )	+	+	+	+	+	+	+	+	
81	050-2149173, .066-017-02-03	-	+	+	+	+	+	+	+	+	
	(0642)-330242, (0642)-331186,	" "	+	+	+	+	+	+	+	+	



96-	. 095-3868985	-									
49-	(0642)-505783, . 095-3624248		+	+	+	+	+	+	+	+	+
, 61	. 066-0640564, . 050-5809230	-	-	-	-	+	-	-	-	-	-
1	(06434)-26025, . 099-2710147	-	+	+	+	+	+	+	+	+	+
, 1	(0332)-290752	" -									
		"	+	+	+	-	-	-	-	+	
, 15-	(0332)-779955, . 097-0482596	-	+	+	+	+	+	+	+	+	+
15-	(032)-2445340, (032)-2445344		+	+	+	+	+	+	+	+	+
, 2	(032)-2471499	-	+	+	+	-	-	+	+	+	+
28	(032)-2395152, (032)-2395577, (032)-2955028, (032)-2955029	" -	+	+	+	+	+	+	+	+	+
116	(032)-2458052	" -	+	+	+	-	-	+	+	+	+
, 242	(0623)-225550, . 066-1032288, . 097-7768120		+	+	+	-	-	-	-	-	-
. 50- , 32\18	(0629)-496005, (0629)-493006		+	+	+	+	+	-	+	+	+
227	(0629)-473000, . 098-3122628, . 095-0282628	" - ( - )	+	+	+	+	+	-	+	+	+
84	(0629)-491881, . 067-5975615		+	+	+	+	+	-	+	+	+
, 42	(0619)-444400	( - )	-	-	+	+	+	+	+	+	+

, 51-	(04337)-64847, (0432)-468213	-	+	+	+	+	+	+	+	+	+
, 46	(03131)-37337, (03131)-37336, . 099-7974430, . 097-3423551		+	+	+	-	+	+	-	+	-
, 33	(0512)-470496, (0512)-478348	" -	+	+	+	+	+	+	+	+	+
2	(0512)-580647		+	+	+	+	+	+	+	+	-
, 49	(0512)-582180, 067-5170570, . 066-7056444	" -	-	+	+	+	+	+	+	+	-
2 97,	(05662)-41503, . 099-0743553	" - - "	+	+	+	+	+	+	+	+	+
	(0566)-688563, . 0505800296	( )	+	+	+	+	+	+	+	+	+
, 189	(0566)-687014	-	-	+	+	+	+	+	+	+	+
, 25	. 095-7247266	-	+	+	+	+	+	+	+	+	-
, 38	(04141)-52010	" "	+	+	+	+	+	+	-	+	+
, 38	(048)-7001737 (048)-7874579		+	+	+	+	+	+	+	+	+
, 90	(0482)-390618, . 094-8390619	-	+	+	+	+	+	+	-	+	+
55	(048)-7229779 (048)-7712538, (048)-7227066	- -	+	+	+	+	+	+	+	+	+
, 27	(048)-7317703, (048)-7317704		+	+	+	-	-	-	-	+	+
( , 66)	(05632)-61554, (05632)-62342		+	+	+	+	+	+	-	+	+
172-	. 096-2840836, . 066-0857539	- ,	+	+	+	+	+	+	+	+	+
75		-	+	+	+	+	+	+	+	+	+

, 29	(0532)-694262, . 099-601424		+	+	+	+	+	+	+	+	+
, 120	(0532)-509889, . 050-0137217		+	+	+	+	+	+	-	+	+
, 66	(0532)-615621	-	+	+	+	+	+	+	+	+	+
, 64	. 099-4243675	-	+	+	+	+	+	+	+	+	+
, 101/1	(04637)-38595, . 095-8862199, . 063-5974127, . 067-2725751	-	-	+	+	+	+	+	+	+	+
, 12	(0362)-266585	-	+	+	+	+	+	+	-	+	+
, 55	(0362)-436452, (0362)-635489, . 067-2385635	-	+	+	+	+	+	+	+	+	+
, 12	. 097-7804458	-	+	+	+	+	+	+	-	+	+
, 5	(0362) 43-33-40, . 067-3604242		+	+	+	+	+	+	+	+	+
, 14	(06563)-22183, . 050-9045717	-	+	+	+	+	+	+	+	+	+
1	(06434)-26025, . 099-2710147	-	+	+	+	+	+	+	+	+	+
, 26-	(0692)-555643 (0692)-453699		+	+	+	+	+	+	+	+	+
, 24	(06452)-50533, . 050-6037272	-	+	+	+	+	+	+	+	+	+
17/1	(0652)-522771, (0652)-544573	" - "	+	+	+	+	+	+	-	+	+
, 72	(0652)-690778	-	+	+	+	+	+	+	+	+	+
, 32	(04733)-46182	-	+	+	+	+	+	+	+	+	+
	(06444)-40289,	-									

, 1	. 066-1053966		+	+	+	+	+	+	-	+	+
\10	(03245)-58381	-	+	+	+	-	-	-	-	-	-
19	. 096-3400696		+	+	+	+	+	+	+	+	+
, 2	. 067-3576378, . 050-5124887	" - "	+	+	+	+	+	+	+	+	+
1/24	(04744)-46614, (04744)-46134	" - "	+	+	+	-	-	-	-	-	-
3/2	(0312)-654266, . 099-5575307	-	+	+	+	+	+	+	+	+	+
, 3	(057)- 73497 24, (057)-7125181	-	+	+	+	+	-	+	+	-	-
, 12	(057)- 71713 39, (057)-7021620	-	+	+	+	+	+	+	+	+	+
, 18	. 096-5953746	" - "	+	+	+	-	-	+	+	+	+
( 42 )			+	+	+	-	-	+	+	+	+
, 25	(057)-7513432, (057)-7643383, . 067-5757009	-	-	-	-	+	+	-	-	-	-
, 35	(0552)-420235	-	-	-	-	+	-	-	-	-	-
, 28-	(0552)-434040, . 050-4946043		+	+	+	+	+	+	+	+	+
, 23	(0552)-296042	-	+	+	+	+	+	+	+	+	+
, 7	(0382)-664501, . 0630750889	-	+	+	+	-	-	+	+	+	+
, 2	(0382)-704700, (0382)-704707, (03822)-664616	-	+	+	+	+	+	+	-	-	-
, 18	(0382)-783773, (0382)-783755		+	+	+	+	+	+	+	+	+
102	(0472)-563478, (0472)-500354, (0472)-564216, . 096-5056363	" - "	+	+	+	+	+	+	+	+	+
, 71	(0472)-314657, (0472)-565621	" - "	+	+	+	-	-	-	-	-	+

. 77- 1	(0462)-601585	" "	+	+	+	+	+	-	-
. , 265-	(0372)-584301, (0372)-584249	" -	+	+	+	+	+	-	+
. , 101	(0372)-571204, .066-6604161	-	+	+	+	+	+	+	+
. , 105	(0372)-554869, .050-4345529		+	+	+	-	+	+	+
. , 3	(03840)-40017, .067-3601632		+	+	+	+	+	+	+
3	(0654)-343051, (0654)-343160, .095-7307151	" - "	+	+	+	+	+	-	+

#### WARRANTY COUPON

GB

When purchasing the product,  
please require its checking before you;  
**BE SURE**

that the goods sold to you, are functional and complete  
and that the warranty coupon is filled in correctly.

This warranty coupon confirms the absence of any defects in the product you purchased and provides for free of charge repair of the product failed through the fault of the manufacturer throughout the period of warranty service and free of charge repair.

Failing the presentation of this coupon, in case of its improper filling in, infringement of factory seals (if any), and also in cases indicated in the warranty obligations, the claims are not accepted, and no warranty service and free of charge repair is made!

The warranty coupon is valid only in the original copy with the stamp of trading organization, signature of the seller, date of sale and signature of the buyer.

Complex home appliances should be installed by supplier's authorized service centers, authorized specialists. In the case of a malfunction of the home appliance because of incorrect installation, the buyer must pay the cost of the visit (call) of the specialist, as well as the cost of fault diagnostics if necessary.

CZ

#### ZÁRUČNÍ LIST

Při koupi výrobku  
žádejte o jeho vyzkoušení ve Vaší přítomnosti,  
**PEŠV DTE SE,**  
že Vám prodaný výrobek je dobře fungující a kompletní  
a že záruční list je vyplněn správně.

Tento záruční list potvrzuje, že na Vámi koupeném výrobku nejsou žádné vady a zajišťuje bezplatnou opravu nefungujícího přístroje z viny výrobce, během celé záruční doby.

Bez předložení tohoto listu, při jeho nesprávném vyplnění, porušení plomb výrobce (jsou-li na výrobku) a také v případech, které jsou uvedené v záručním listě, nároky se nepřijímají a záruční oprava se neprovádí!

Záruční list je platný jenom jako originál s razítkem obchodní organizace, podpisem prodávajícího, termínem prodeje a podpisem zákazníka.

Instalace komplexní spotřebiče musí být provedena autorizovaným servisním střediskem, specialistou. V případě poruchy v důsledku nesprávné instalace výrobku, kupující je povinen uhradit náklady na výjezd (volání) odborný, pokud je to nezbytné, a náklady na diagnostiku poruch.

RU

( )

( )

# Saturn®

WARRANTY COUPON

ZÁRUČNÍ LIST

SATURN HOME APPLIANCES S.R.O. KONVOVA 141, 13083  
PRAHA 3 – ŽIŽKOV, ČESKÁ REPUBLIKA, TEL: + 4202/ 67 108 392

Model/

Serial number/Sériové číslo/ /

Date of sell/Termín prodeje/ /

Shop stamp/Razítko obchodu/ /

Seller's signature/Podpis prodávatele/ /

Buyer's Signature confirming the acquaintance and consent with terms of free of charge maintenance service of the product, and absence of the complaints on appearance and color of the product.

Podpis zákazníka, potvrzující seznámení a souhlas s podmínkami Bezplatného záručního servisu výrobku, a také neexistence nároků na vzhled a barvu výrobku.

**ВІДМІТКИ ПРО ВСТАНОВЛЕННЯ ВИРОБУ\***

Дата встановлення	Назва організації, СЦ	№ наряду	ПІБ та підпис майстра
			ПІБ та підпис споживача**

\*Тюбові прилади, для введення в експлуатацію котрих необхідні установочні, монтажні роботи, повинні вводиться в експлуатацію уповноваженими спеціалістами сервісних центрів постачальника. В разі виникнення несправності виробу з причини некоректної установки вироб може бути знятий з гарантійного обслуговування, а покупець повинен сплатити вартість виїзду (виклику) фахівця, а в разі необхідності і вартість діагностування несправності.

**ВІДМІТКИ ПРО ПРОВЕДЕННЯ СЕРВІСНОГО ОБСЛУГОВУВАННЯ**

Дата прийому в ремонт	Завлений споживачем недолік	№ наряду	Назва організації, СЦ	Перелік виконаних робіт	Перелік встановлених запчастин	Дата завершення ремонту	ПІБ та підпис майстра	
							ПІБ та підпис споживача**	

\*\* Підпис споживача свідчить про приймання виробу в робочому стані.

**ОТМЕТКИ ОБ УСТАНОВКЕ ИЗДЕЛИЯ\***

Дата установки	Название организации, СЦ	№ наряда	ФИО и подпись мастера
			ФИО и подпись потребителя**

\*Бытовые приборы, для ввода в эксплуатацию которых необходимы установочные, монтажные работы, должны вводиться в эксплуатацию уполномоченными специалистами сервисных центров поставщика. В случае возникновения несправности по причине некорректной установки, изделие может быть снято с гарантийного обслуживания, а покупатель должен оплатить стоимость выезда (вызова) специалиста, а в случае необходимости и стоимость диагностики неисправности.

**ОТМЕТКИ О ПРОВЕДЕНИИ СЕРВИСНОГО ОБСЛУЖИВАНИЯ**

Дата приема в ремонт	Завленный потребителем недостаток	№ наряда	Название организации, СЦ	Перечень выполненных работ	Перечень установленных запчастей	Дата завершения ремонта	ФИО и подпись мастера	
							ФИО и подпись потребителя**	

\*\* Подпись потребителя свидетельствует о приеме изделия в рабочем состоянии.

**NOTES ABOUT THE INSTALLATION OF THE DEVICE\***

Installation date	Name of organization, Service Center	Order No	Master's surname, name, patronymic and signature Client's surname, name, patronymic and signature**

\* Household appliances for commissioning of which installation and mounting works are required should be commissioning by the supplier's authorized service center specialists. In the case of a malfunction of the product because of incorrect installation, the product may become invalid for warranty service, and the buyer must pay the cost of the visit (call) of the specialist, as well as the cost of fault diagnostics if necessary.

**NOTES ABOUT CARRYING OUT OF SERVICE MAINTENANCE**

Date of receipt for repair	Client's declared problem	Order No	Name of organization, SC	List of performed work	List of installed spare parts	The repair end date	Master's surname, name, patronymic and signature Client's surname, name, patronymic and signature**

\*\* Client's signature certifies about the appliance's receipt at the working condition.

Model/	Model/	Model/	<b>Saturn</b>	<b>Saturn</b>	<b>Saturn</b>
Date of sale/ /	Date of sale/ /	Date of sale/ /	Date of sale/ /	Date of sale/ /	Date of sale/ /
Serial number/ /	Serial number/ /	Serial number/ /	Serial number/ /	Serial number/ /	Serial number/ /
Name of the Trade company and Stamp/ /	Name of the Trade company and Stamp/ /	Name of the Trade company and Stamp/ /	Name of the Trade company and Stamp/ /	Name of the Trade company and Stamp/ /	Name of the Trade company and Stamp/ /
Customer's address, phone#, name, surname/ /	Customer's address, phone#, name, surname/ /	Customer's address, phone#, name, surname/ /	Customer's address, phone#, name, surname/ /	Customer's address, phone#, name, surname/ /	Customer's address, phone#, name, surname/ /
Date of Receiving/ /	Date of Receiving/ /	Date of Receiving/ /	Date of Receiving/ /	Date of Receiving/ /	Date of Receiving/ /
Date of Return/ /	Date of Return/ /	Date of Return/ /	Date of Return/ /	Date of Return/ /	Date of Return/ /
Defect/ of the Service Center, signature/ /	Defect/ of the Service Center, signature/ /	Defect/ of the Service Center, signature/ /	Defect/ of the Service Center, signature/ /	Defect/ of the Service Center, signature/ /	Defect/ of the Service Center, signature/ /
Stamp/ /	Stamp/ /	Stamp/ /	Stamp/ /	Stamp/ /	Stamp/ /
COUPON 1	COUPON 2	COUPON 3			